



Technical catalogue **PERGOLAS**

1st edition / 2017

Table of contents

System Solid sunbreaker.....04

Solid system - free standing version.....12

Solid system - wall mounted version.....15

Solid Sunbreaker System

available colours	RAL
electric drive	yes
manual drive	no
maximum projection	7 m
maximum width	4 m
rainproof system	yes
roof drainage	yes
modular system	yes
cover	sunbreaker blades

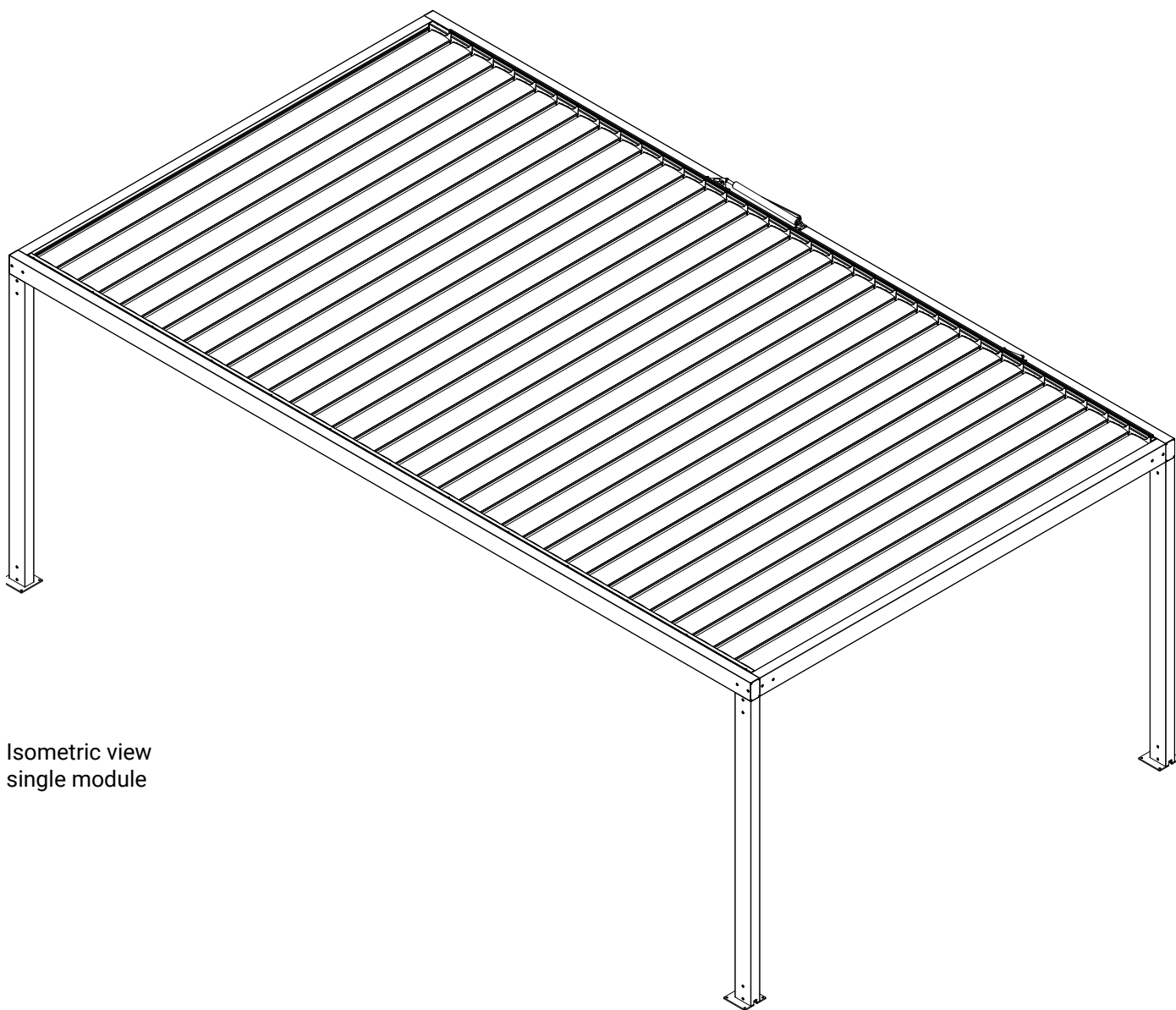

Isometric view
single module

Solid Sunbreaker System

Isometric exploded view - single module

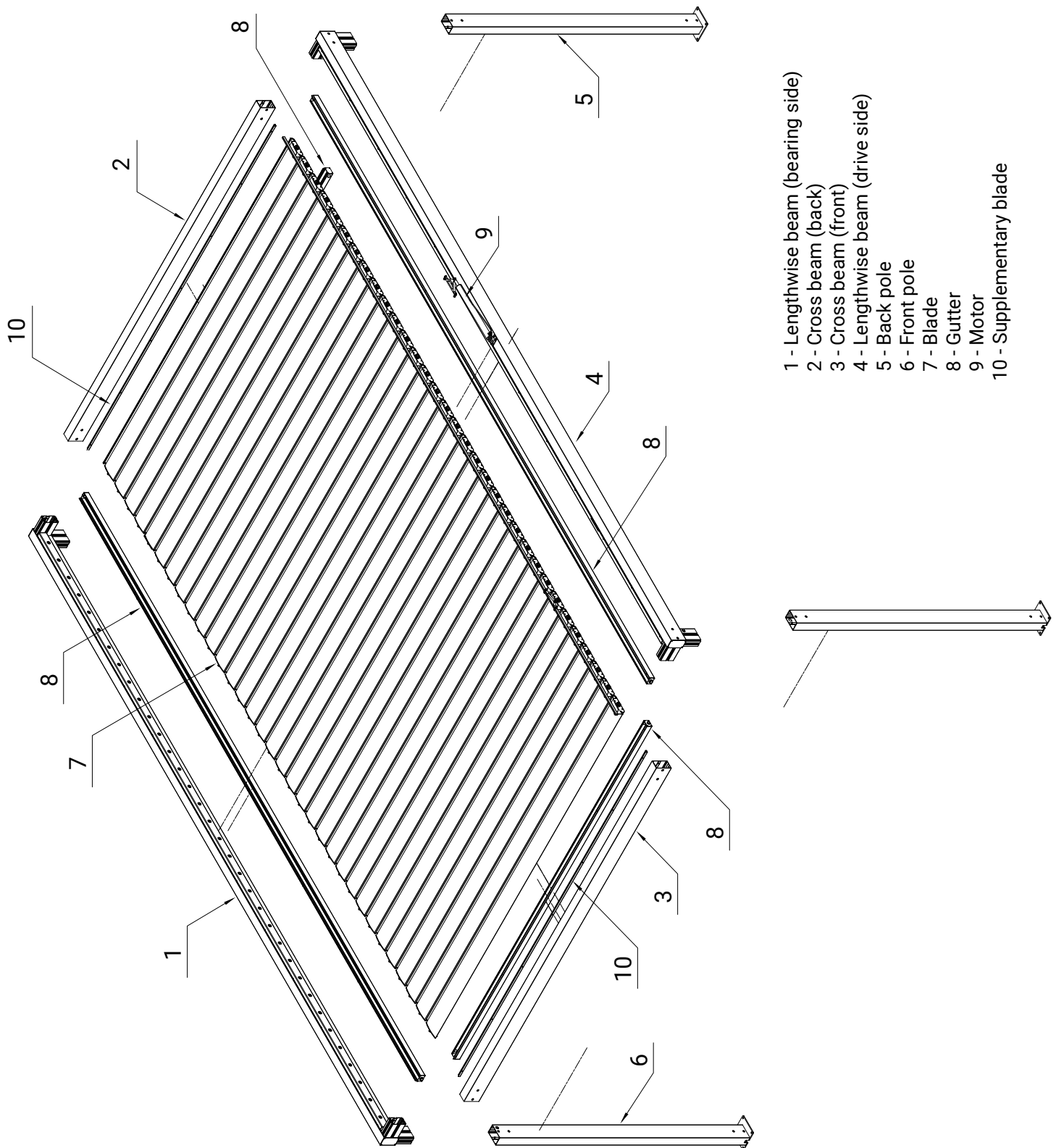

Solid Sunbreaker System

Side view

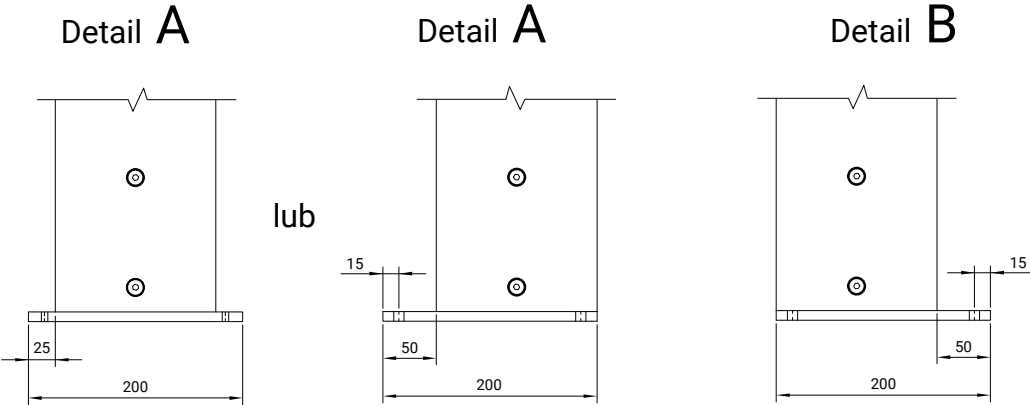
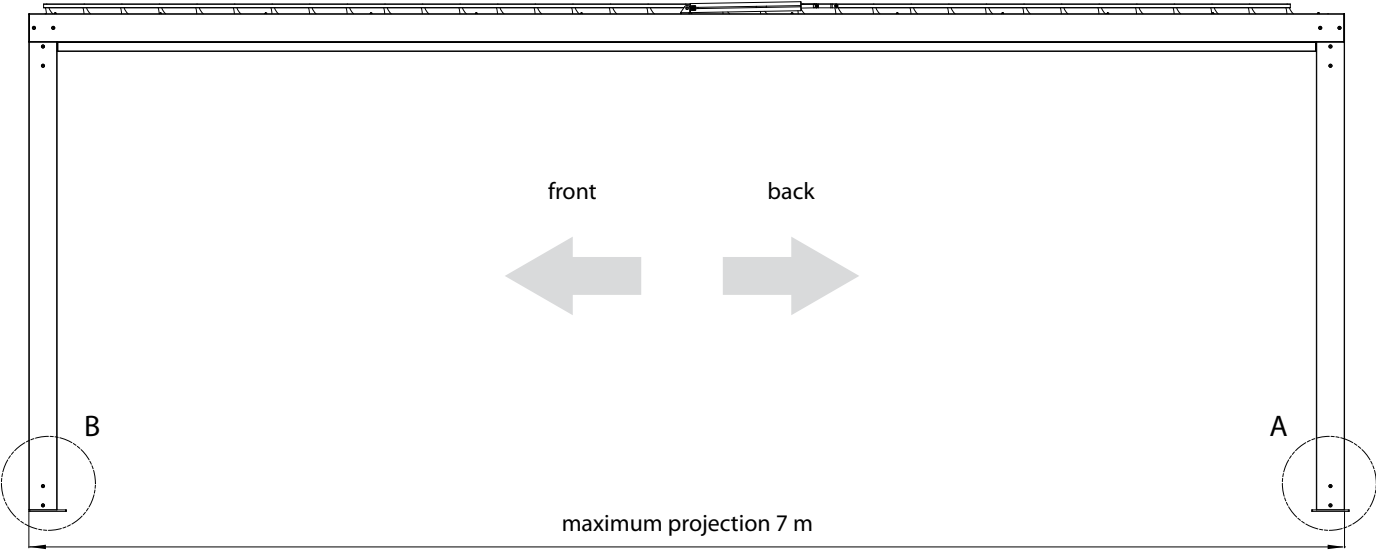

Front view

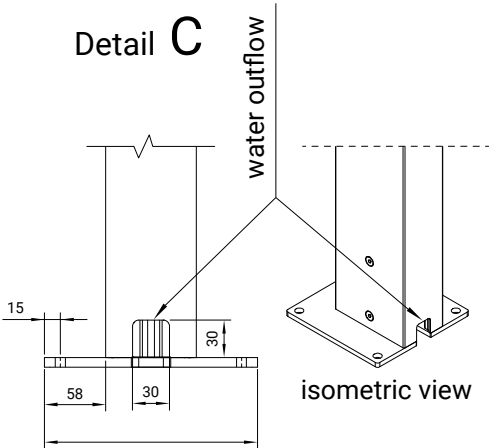
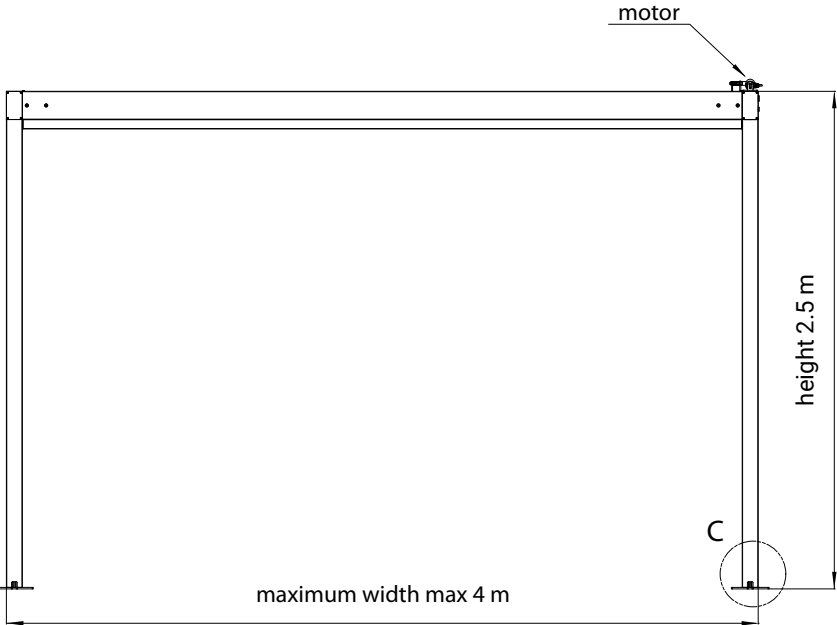

Solid Sunbreaker System

Isometric view
modular system

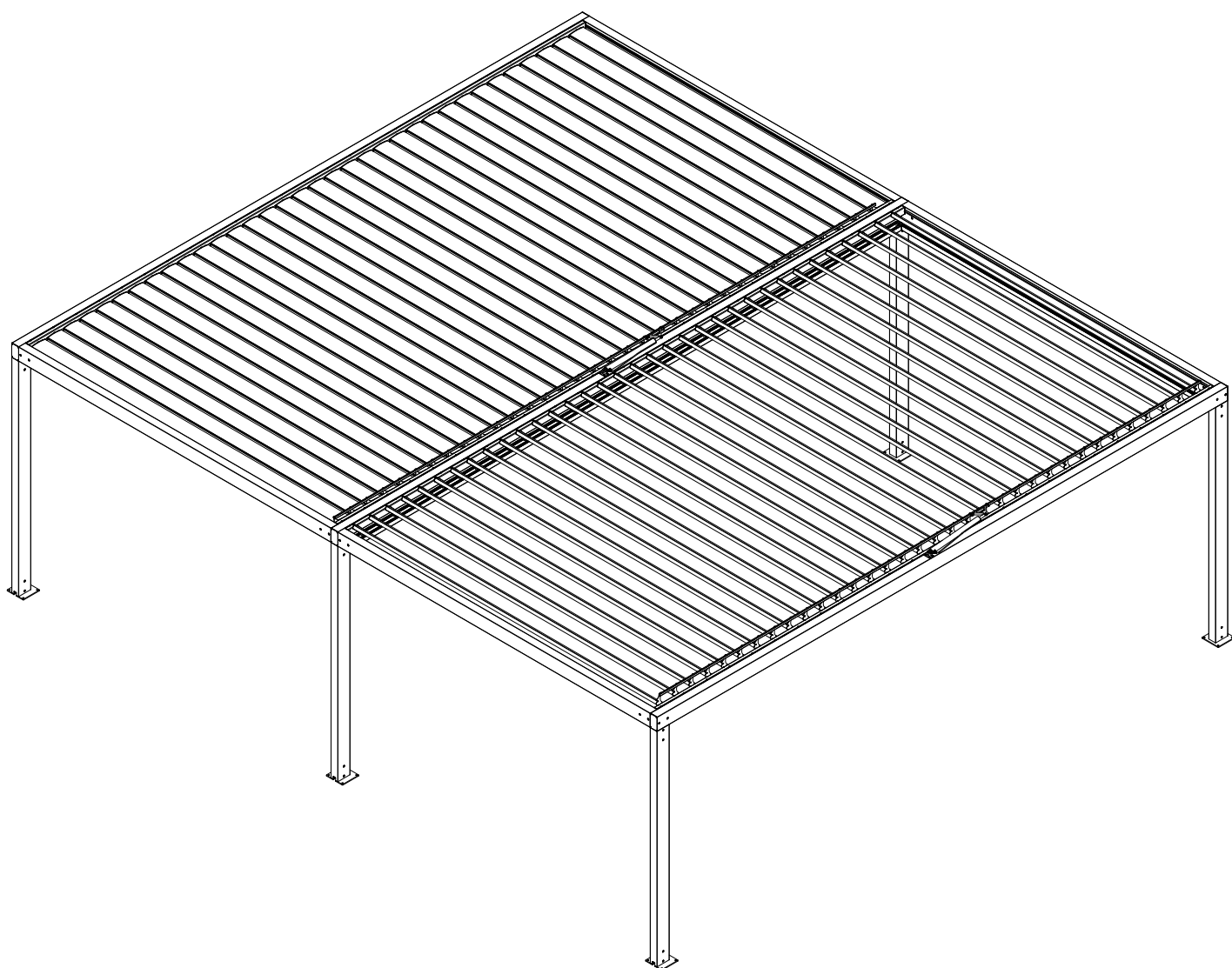

Solid Sunbreaker System

Isometric exploded view

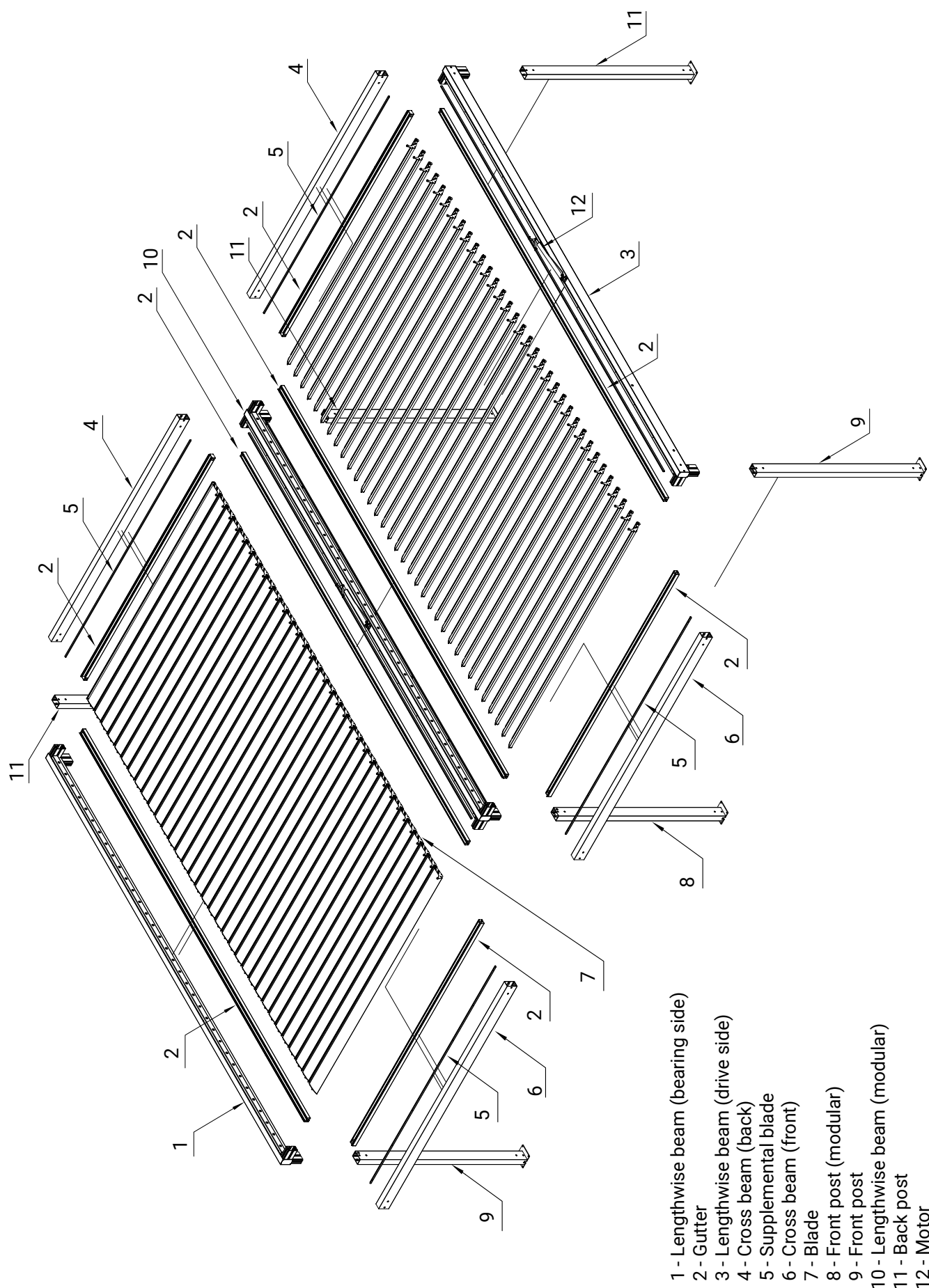

Solid Sunbreaker System

Dimensioning of multi-modular system.

In multi-modular pergola dimensioning of one module follows the same pattern as in single-module pergola. The difference lies in specifying the width.

H - clear height under front bar

X_L - width of the extreme left module (max 4000 mm)

X_C - width of the central modules (max 4000 mm)

X_R - width of the extreme right module (max 4000 mm)

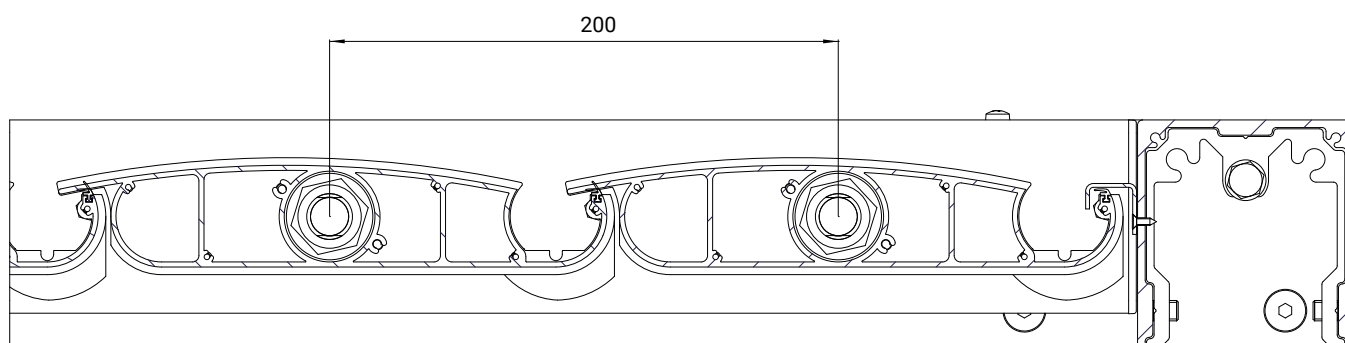
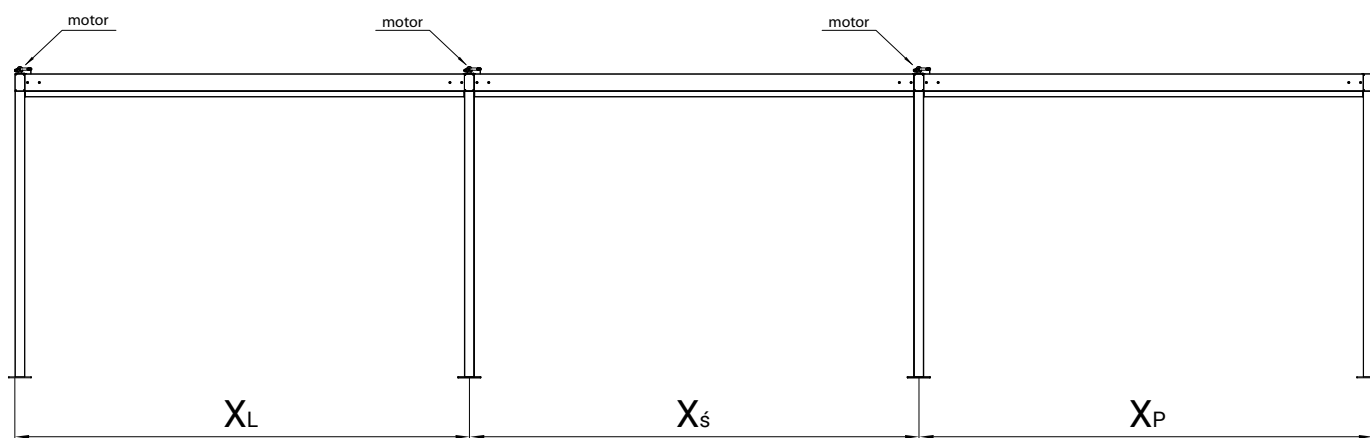

Blades cross section - closed position

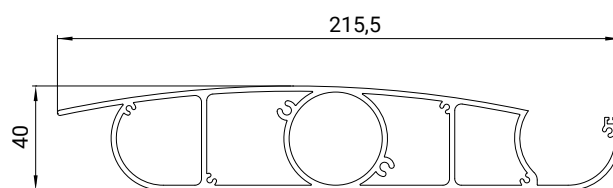

Blade

Solid Sunbreaker System

blade end cap
(bearing)

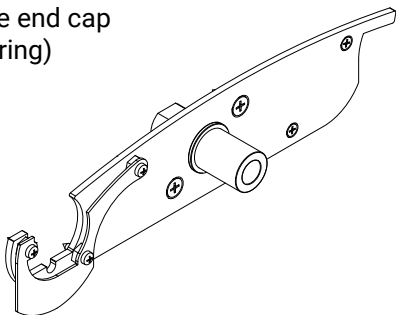

blade end cap
(drive)

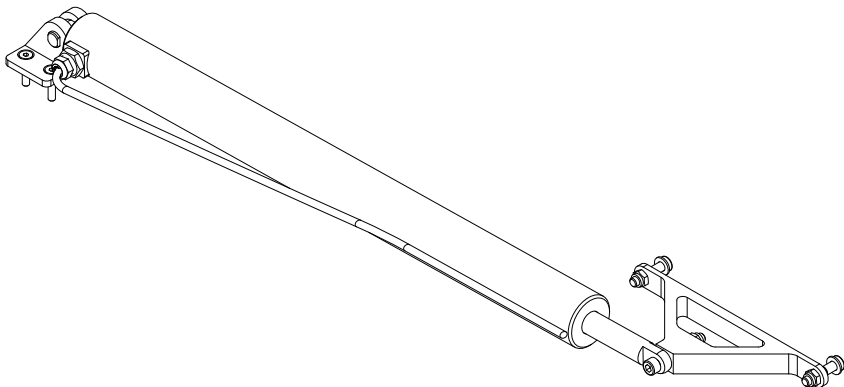
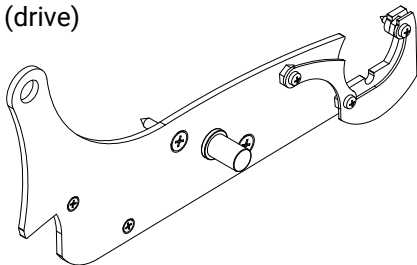

Drive - Picollo XL motor

Drive rod bracket

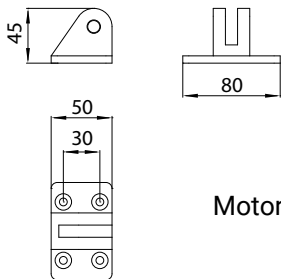
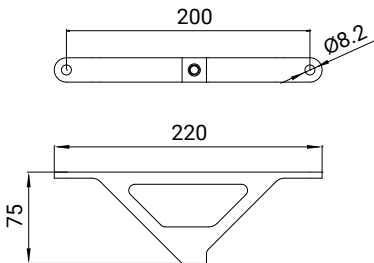

Motor bracket

Water outflow from the blades - gutter

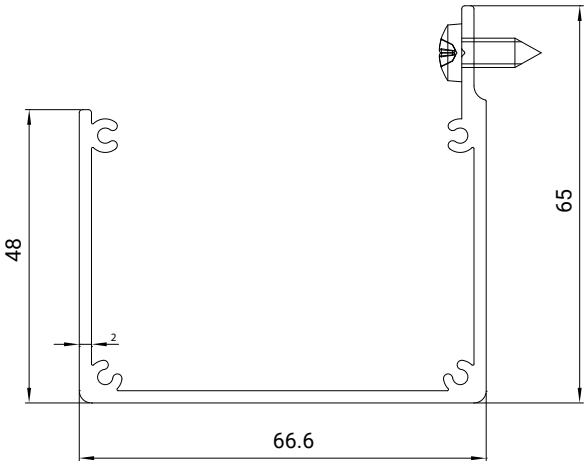

Solid system - free standing version

colour palette	RAL
electric drive	yes
manual drive	no
maximum projection	7 m
maximum width	4 m
tilt angle*	3°-10°
rainproof system	yes
modular system	yes
cover	PVC fabric dedicated for Solid system

* maximum tilt angle depends on the projection

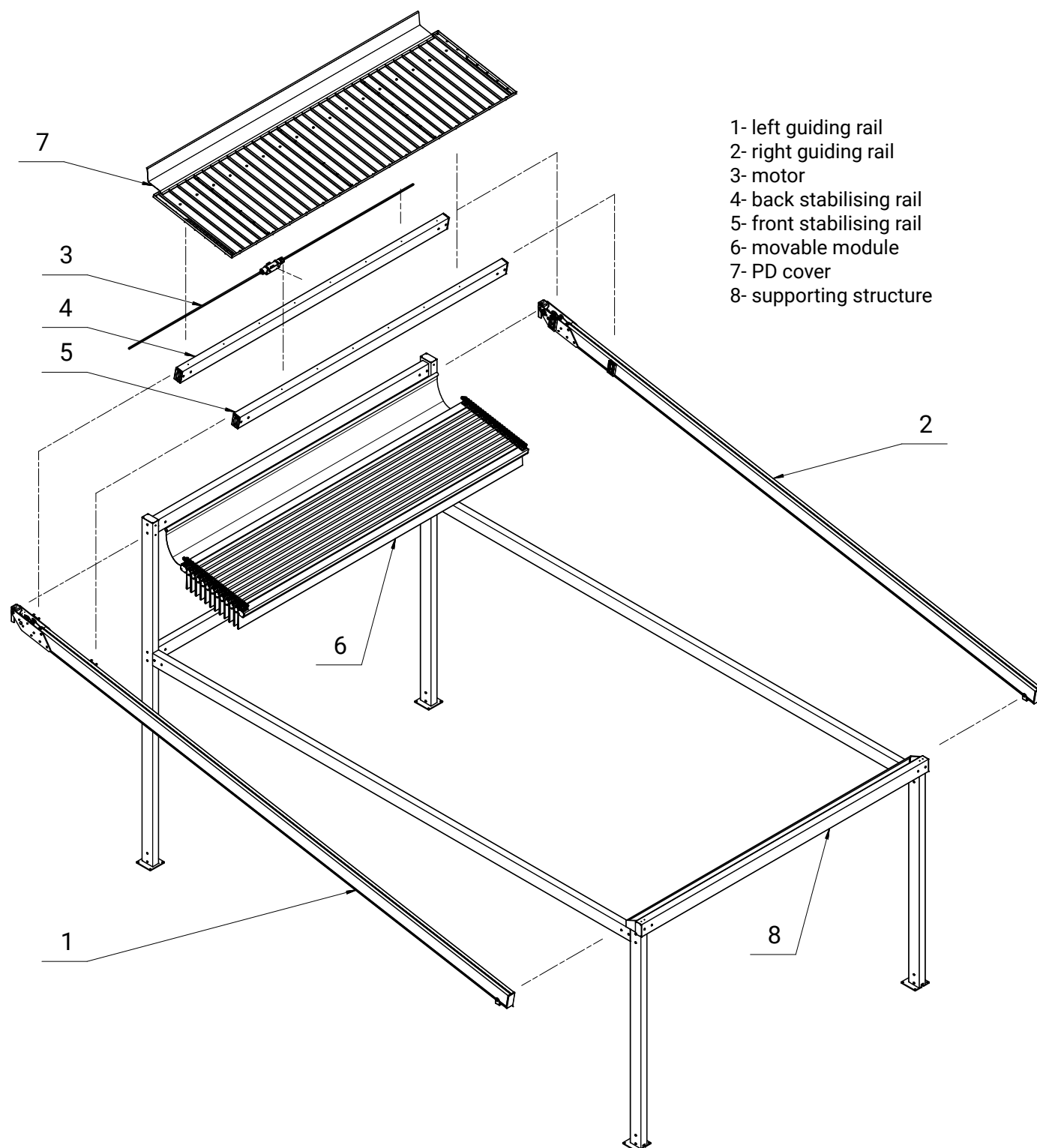

free standing version - **Solid system**

Type of taking measurements of free standing single-modular system

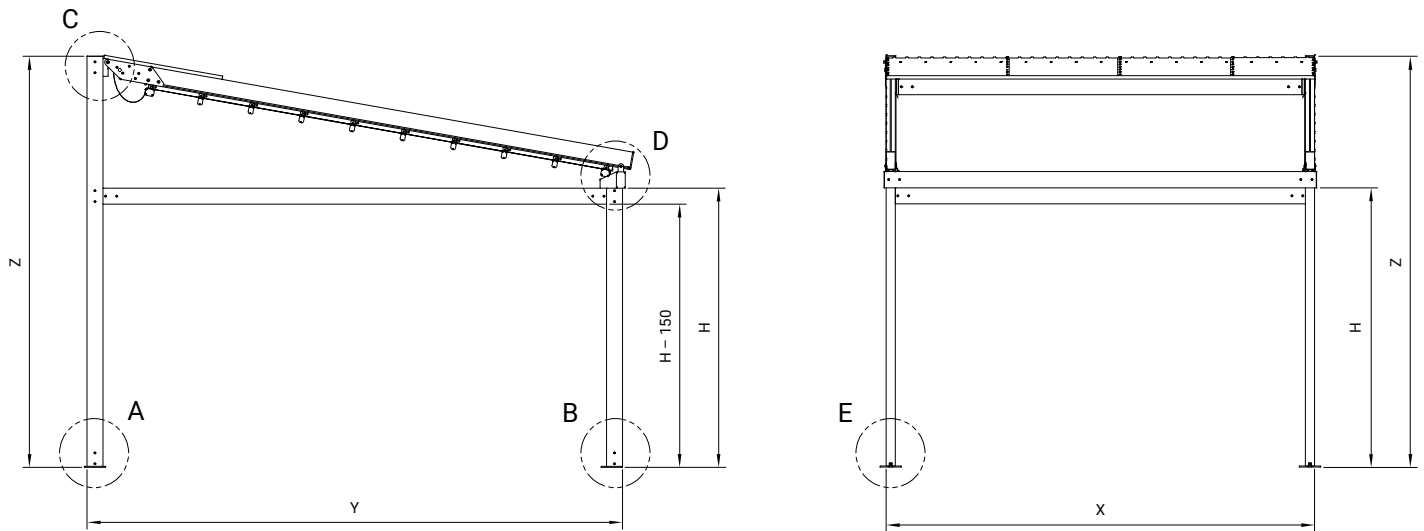

H - clear height under the front bar

X - width of the system (max 4m)

Y - projection of the system (max 7m)

Z - height of the back of the system (to the end of high pole)

Detail A

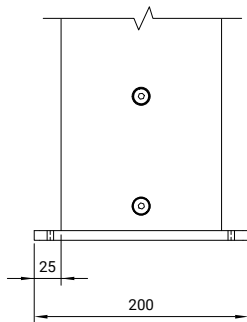

Detail A

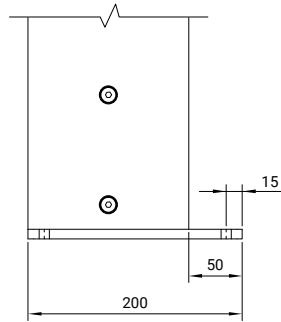

or

Detail B

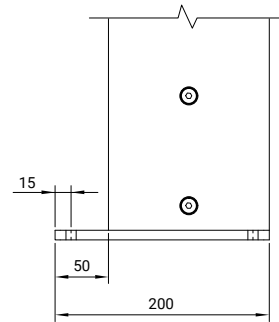

Detail E

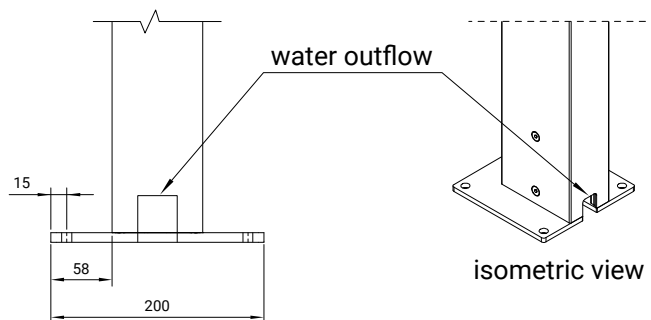

Solid system - free standing version

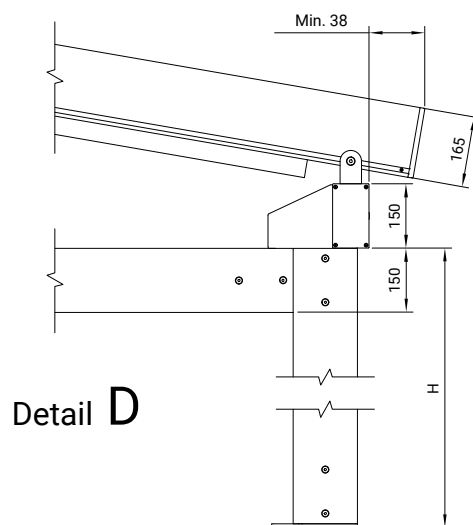
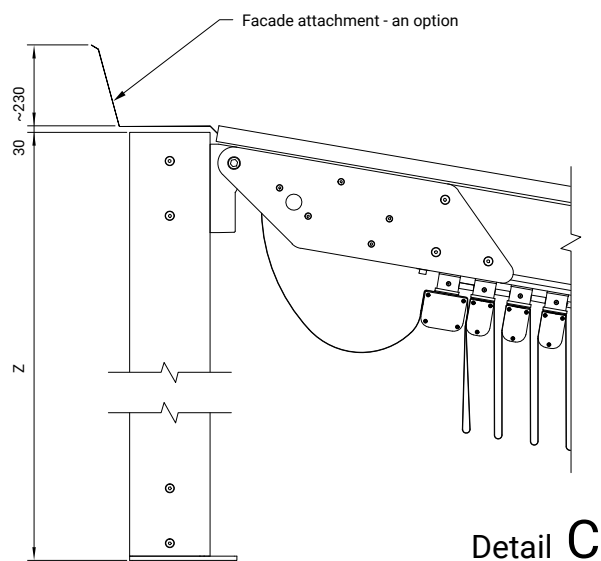

Type of taking measurements of free standing multi-modular system.

For the multi-modular version measurements are like in the similar single-modular systems. The difference is in width of the system.

H - clear height under the front bar

X_L - width of the extreme left system (max 4000 mm)

X_C - width of the central modules (max 4000 mm)

X_R - width of the extreme right module (max 4000 mm)

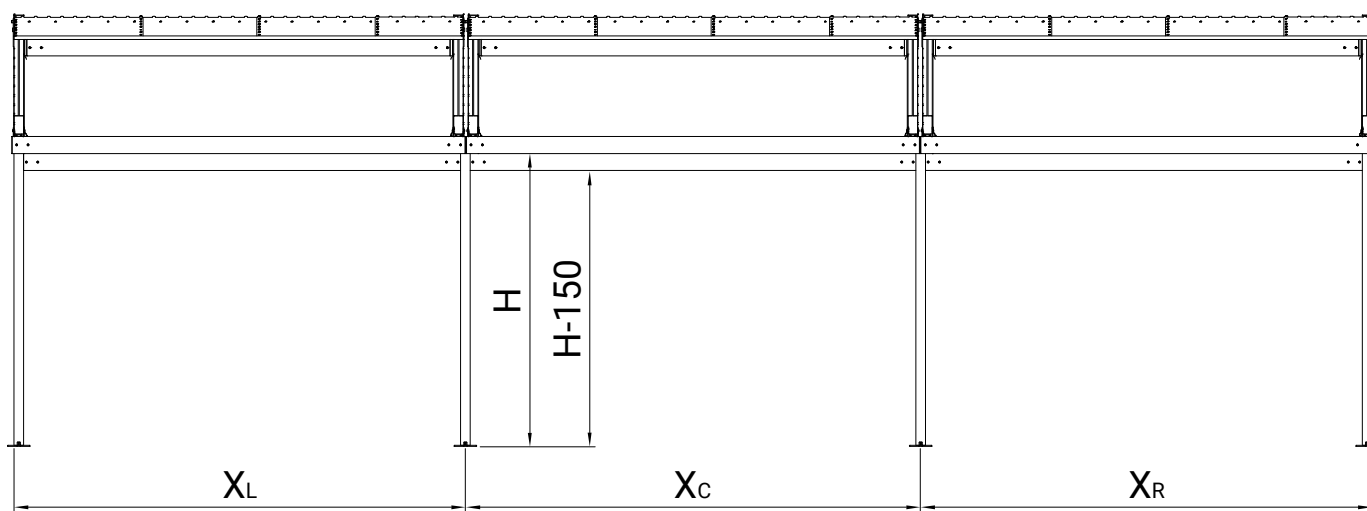

wall-mounted version - **Solid system**

colour palette	RAL
electric drive	yes
manual drive	no
maximum projection	7 m
maximum width	4 m
tilt angle*	3°-10°
rainproof system	yes
modular system	yes
cover	PVC fabric dedicated for Solid system

* maximum tilt angle depends on the projection

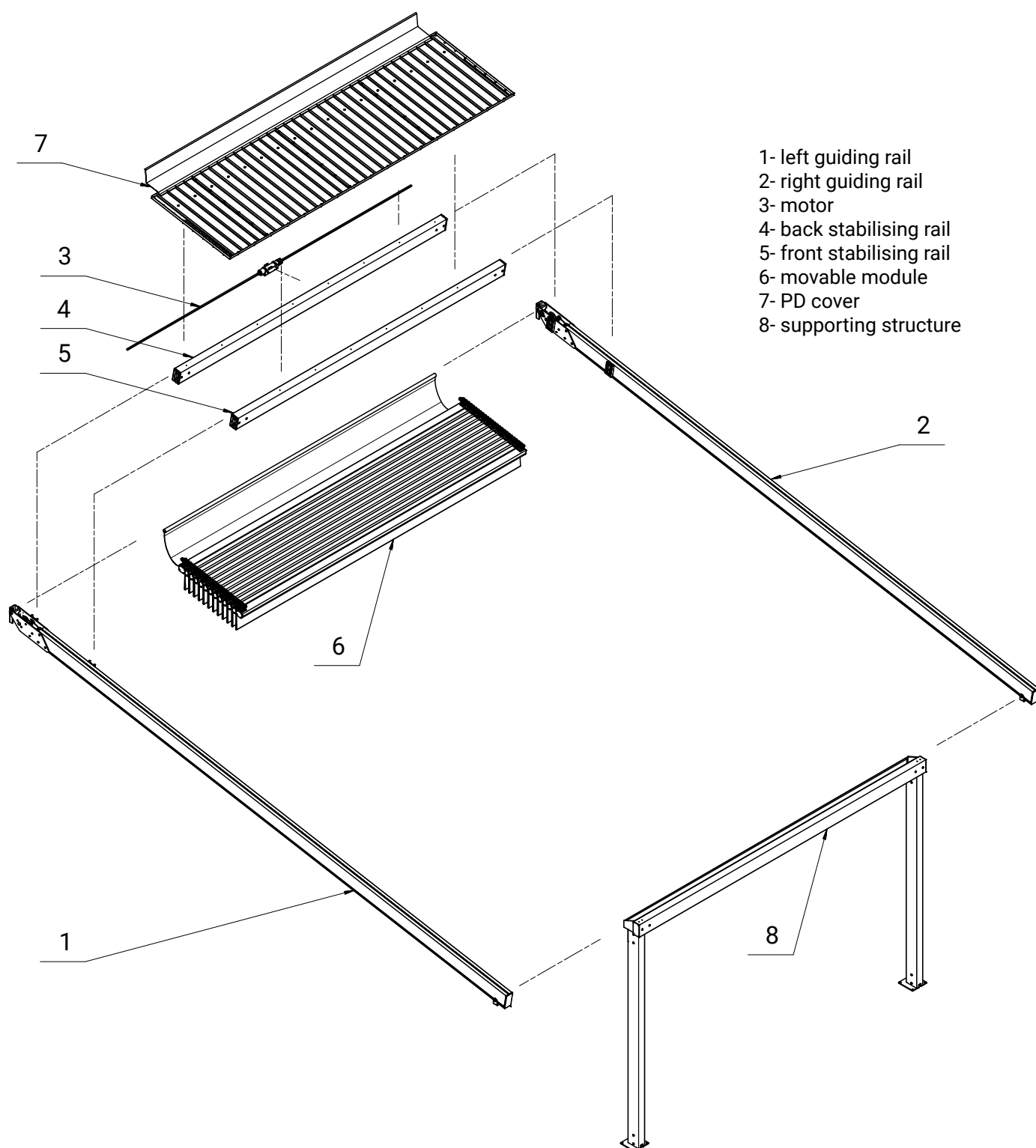

Solid system - wall-mounted version

Type of taking measurements of wall-mounted single-modular system.

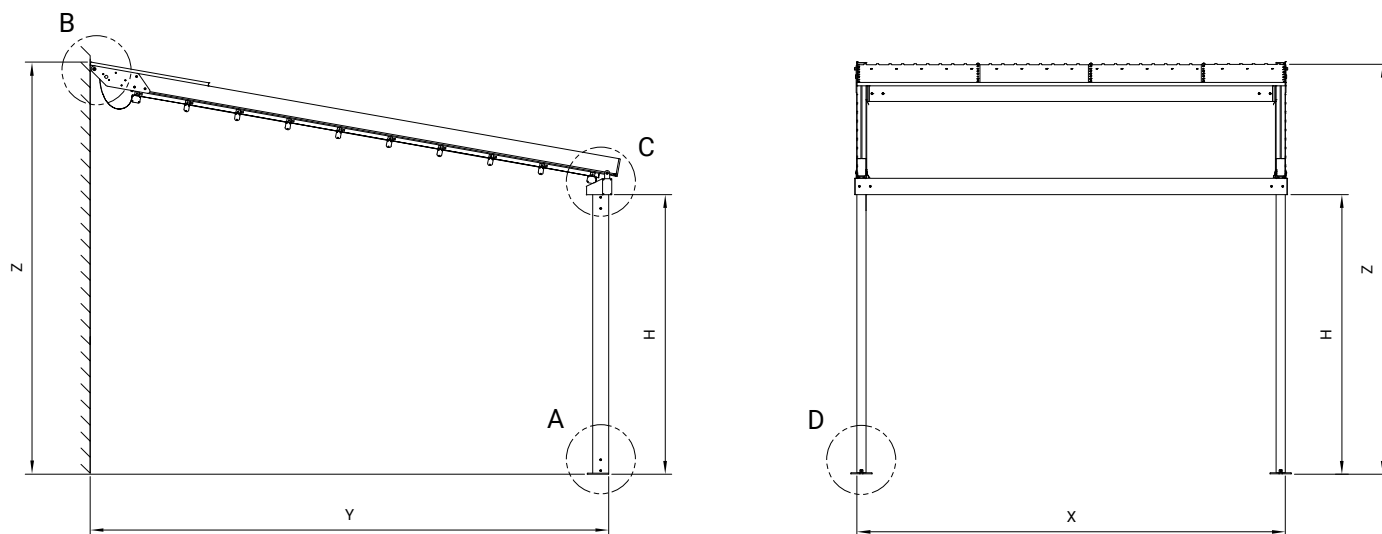

H - clear height under the front bar

X - width of the system (max 4m)

Y - projection of the system (max 7 m)

Z - height of the back of the system (to the upper edge of guide bar bracket)

Detail A

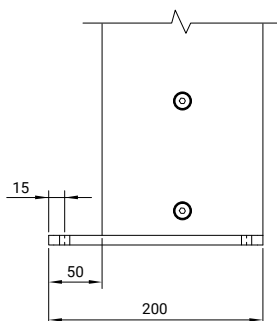

Detail D

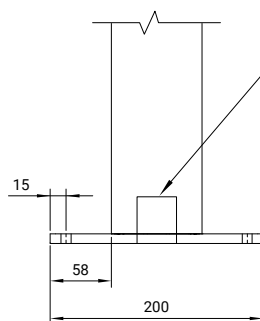

water outflow

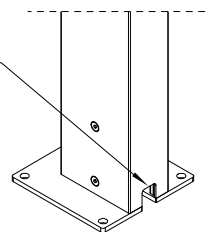

isometric view

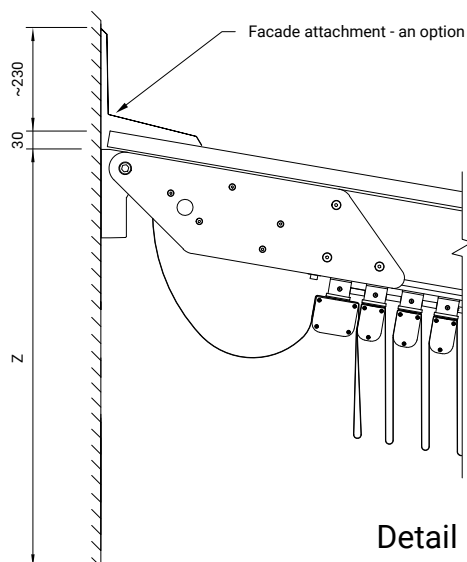

Detail B

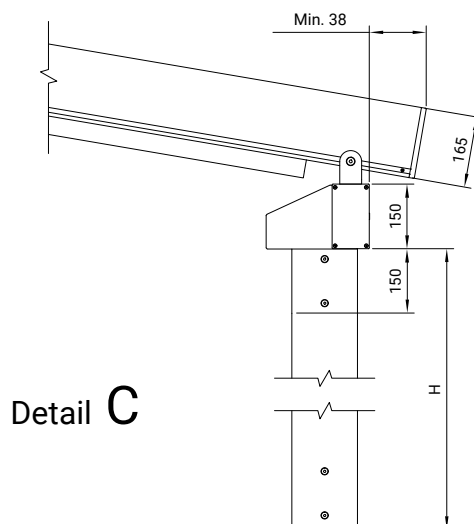

Detail C

In wall-mounted single-modular pergola the back brackets of guide barguide bar are screwed into the wall, substructure, etc.

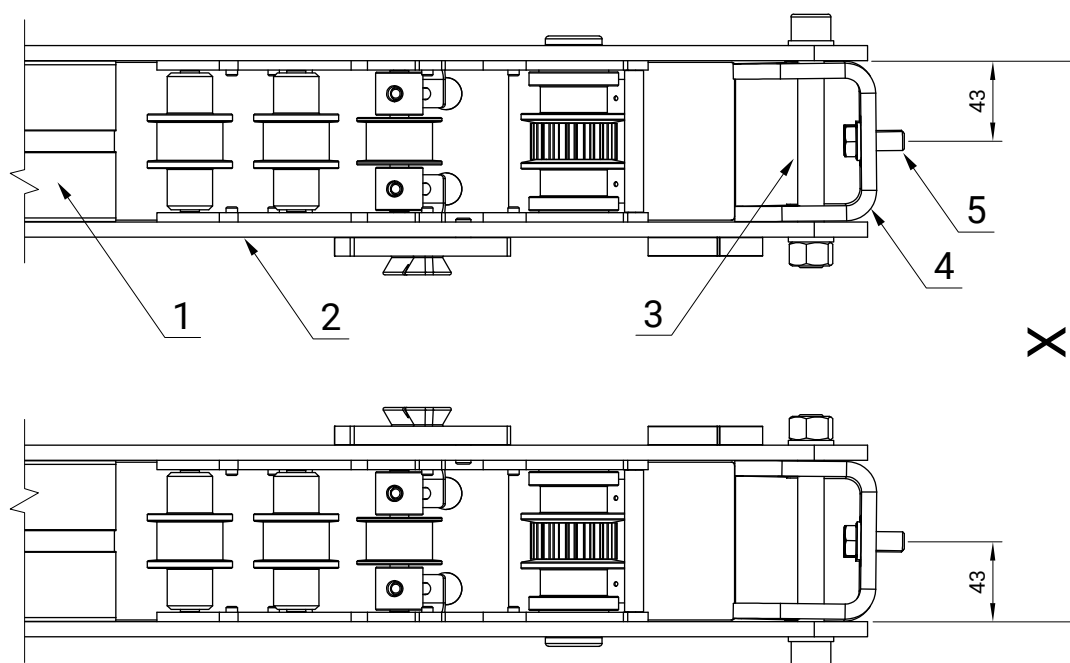

- 1 - guiding rail
- 2 - fastening of the guiding rail
- 3 - screw fixing the rail to the bracket
- 4 - bracket for back guiding rail
- 5 - anchors fixing bracket to the wall
- X - assumptive width of the module

Type of taking measurements of wall-mounted multi-modular version

For the multi-modular version measurements are like in the similar single-modular systems. The difference is in width of the system.

- H - clear height under the front bar
- X_L - width of the extreme left system (max 4000 mm)
- X_C - width of the central modules (max 4000 mm)
- X_R - width of the extreme right module (max 4000 mm)

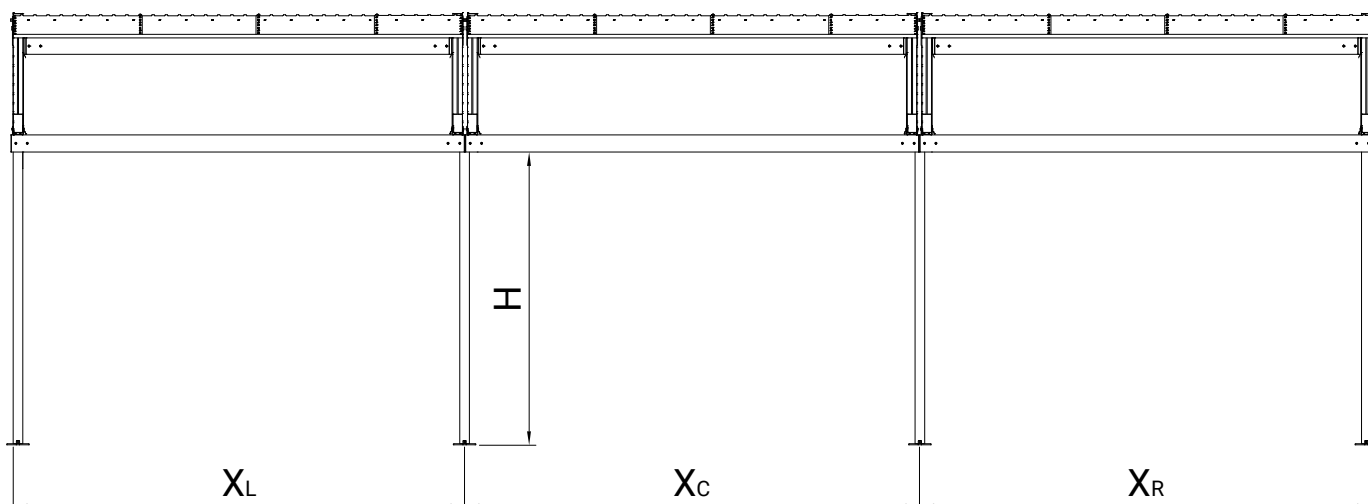

Solid system - wall-mounted version

In wall-mounted multi-modular pergola the back brackets of guide bar are screwed into the wall, substructure, etc.

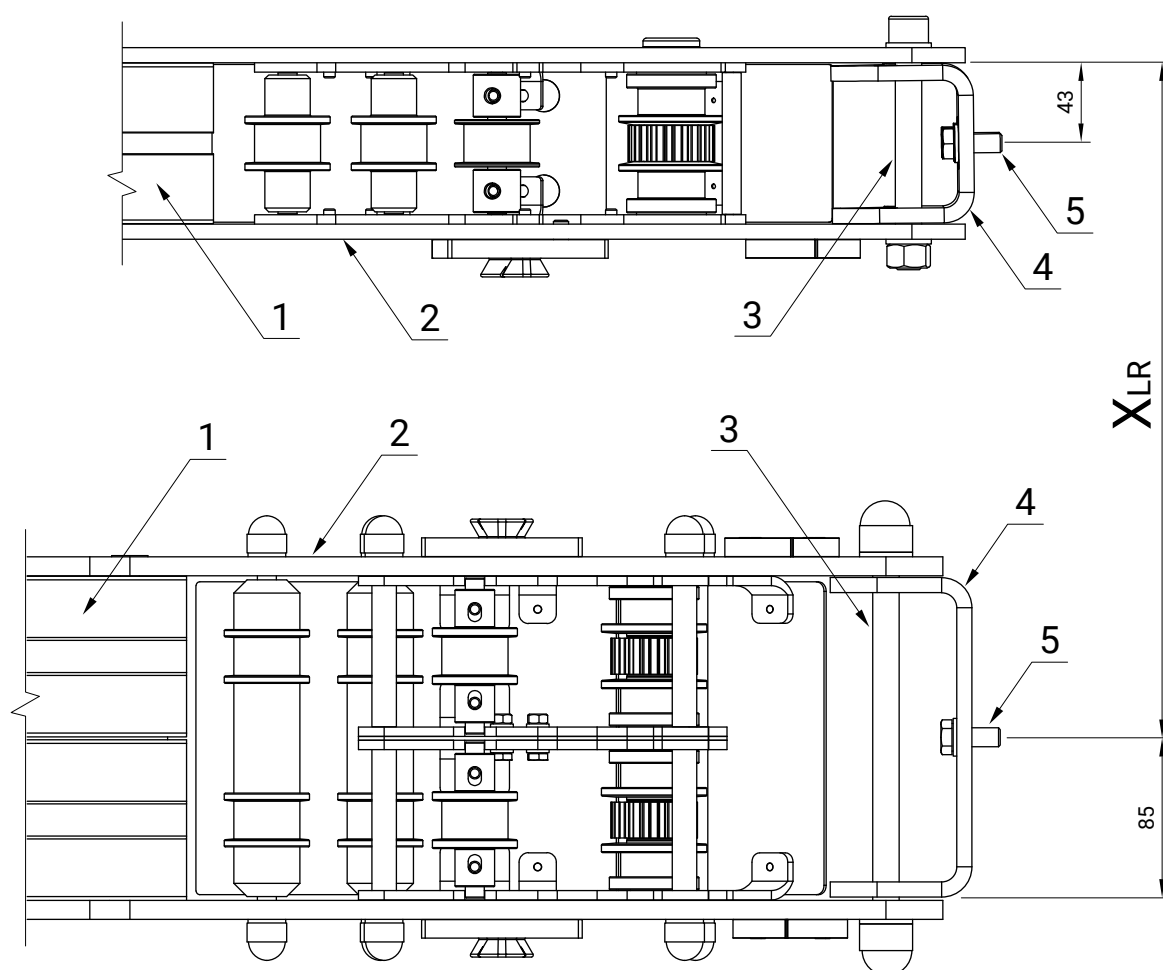

- 1 - guiding rail
- 2 - fastening of the guiding rail
- 3 - screw fixing the rail to the bracket
- 4 - bracket for back guiding rail
- 5 - anchors fixing bracket to the wall
- X_{LP} - assumptive width of the extreme module (left or right)

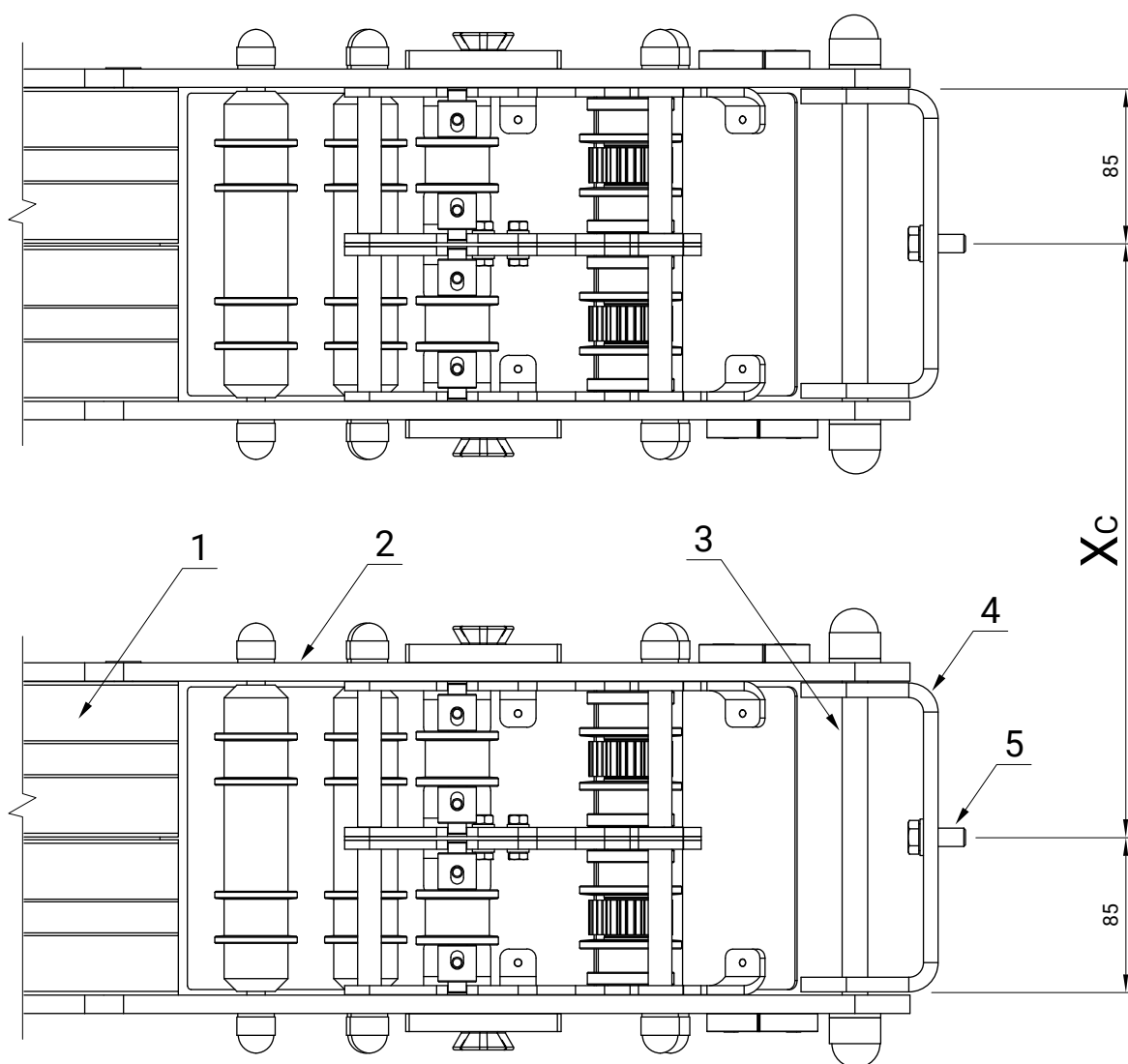

- 1 - guiding rail
- 2 - fastening of the guiding rail
- 3 - screw fixing the rail to the bracket
- 4 - bracket for back guiding rail
- 5 - anchors fixing bracket to the wall
- X_c - assumptive width of the central module

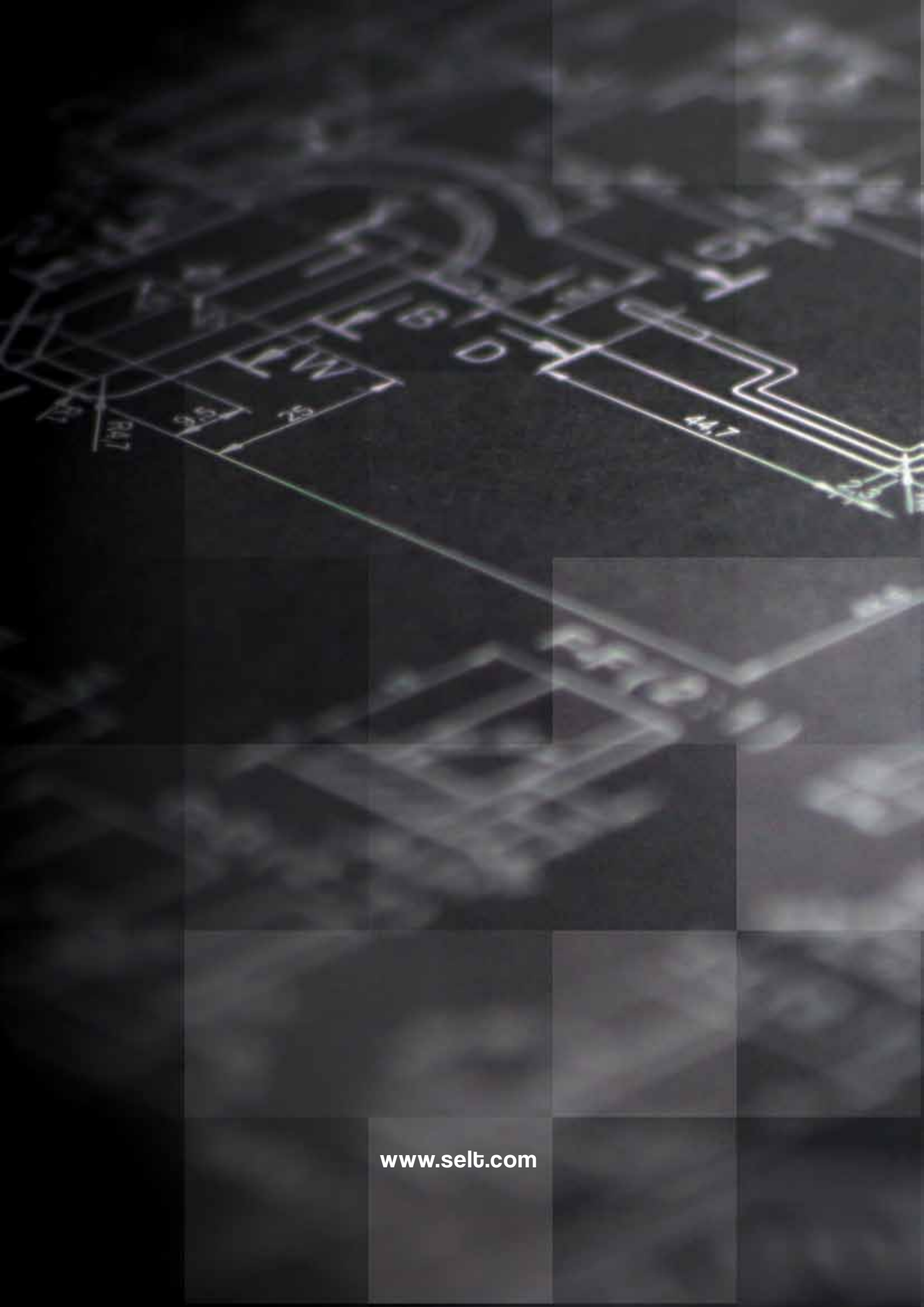

www.selt.com