



CARE GUIDE



BEST DECISION FOR YOUR HOME



PRE-OPERATION

During the transportation process, the fabric used for your Ombra® tends to be tightly wrapped in order to keep it protected. This can cause an unwanted rippling or wrinkling effect after it is installed. To ensure rippling is ironed out, it is best to leave your Ombra® shades down for one to two days in clear weather, until the fabric is fully settled.

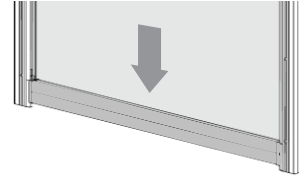

SPRING CONTROL

All Ombra® systems are built to operate smoothly and effortlessly. If it is proving to be difficult to lower or raise your shades, through no fault of your own, please contact your Ombra® retailer.

Lower your shades

Grip the centre of the weight bar and guide the shades downwards, gently. Operation from the centre is crucial to evenly distribute force and ensure a smooth gliding shades. Always handle your Ombra® from the centre of the weight bar.

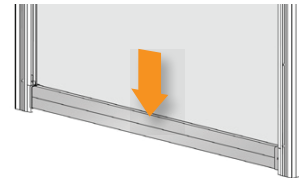

► Systems with Ultra-lock:

Pull the shades downwards until you hear one click. This indicates your shades is now locked. If you hear two clicks, the shade has travelled too low and has unlocked. If so, raise the weight bar and lower it back down to the first click.

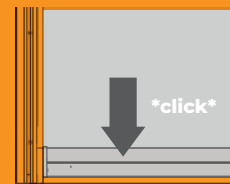

Raise your shades

Grip the centre of the weight bar and guide the shade upwards, gently. Operation from the centre is crucial to evenly distribute force and ensure a smooth gliding shade. Always handle your Ombra® from the centre of the weight bar. If your shade rolls up unevenly, bring the shade down and then begin to raise it again, ensuring both sides of the shade are moving smoothly and evenly.

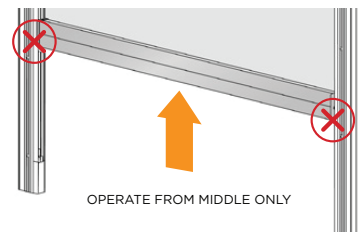

► Systems with Ultra-lock:

Pull the shade downwards until you hear one click. This indicates your shade is now unlocked. Once unlocked, lift the weight bar upwards to raise the shade.

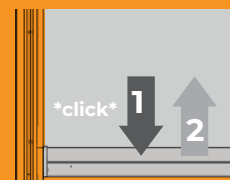

Desired height

Ombra® outdoor shades can be left at any desired height. Simply lower or raise the shade to the desired level and the shade will rest in the position set. To ensure longevity, never forcefully operate your outdoor shade system. If you experience irregular jarring, refer to the 'correct procedure' section of this user guide or see your retailer.

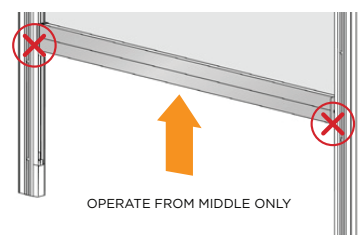



Ombra® PULL STICK

► Extending the Pull Stick

The pull stick can be extended from 1m up to 1.9m. To lock and unlock the Pull Stick, twist the pole and hook in opposite directions.

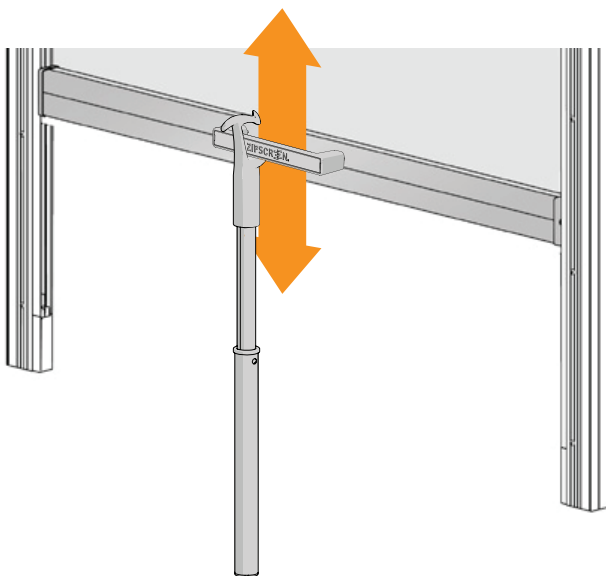
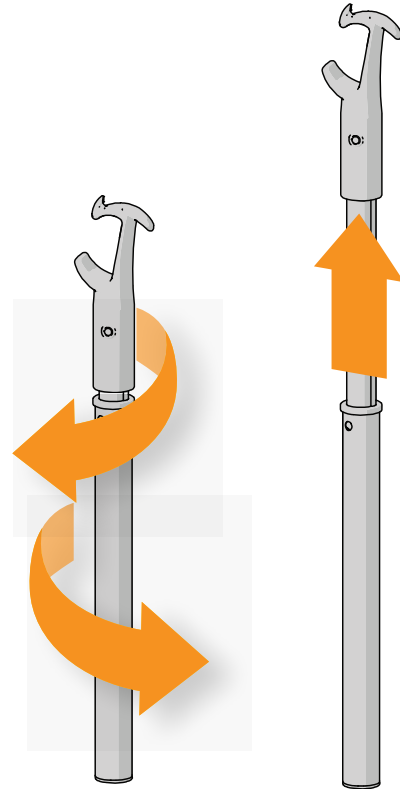

To lower shades

Secure the top of the hook over the handle and guide the shade downwards.

To raise shades

Secure the bottom of the hook under the handle and guide the shade upwards.



CRANK GEAR CONTROL

All Ombra® systems are built to operate smoothly and effortlessly. If it is proving to be difficult to lower or raise your shades, through no fault of your own, please contact your Ombra® retailer.

Attach and detach Crank Gear Handle

Hold the Crank Gear Arm steadily and guide the tip of the arm to the end of the coupling joint at the top of the Ombra®. Firmly push the arm into the coupling joint until it securely clicks into place. To detach the arm, simply pull the arm downwards, away from the coupling joint. The arm will click and dislodge from the coupling joint. Store the arm in a safe place until it needs to be used again.

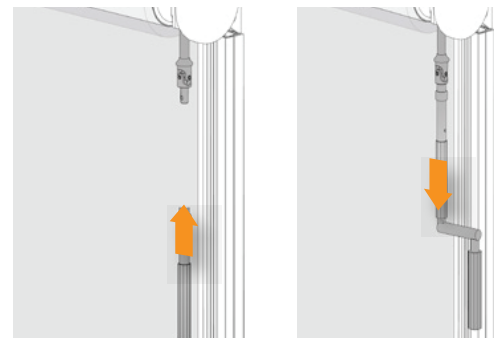

Crank Arm support

If a crank arm support is in use, unfold the arm and ensure the entire arm is straight. Firmly push the crank arm into the support clip to secure it in place. When the crank arm needs to be used, simply pull the arm away from the support to dislodge it from the grip of the support.

Lower your shades

Ensure the Crank arm is connected to the joining arm at the top of the Ombra® and is folded in an 'L' formation. Hold the top grip of the crank arm in one hand and the bottom grip in the other, then rotate the arm counterclockwise to lower the shade.

► Systems with Ultra-lock:

Allow the shades to move downwards until you hear one click. This indicates your shade is now locked. If you hear two clicks, then the shade has travelled too low and has unlocked. If so, crank the arm in a clockwise direction to raise the shade and then lower it back down until you hear the first click. Once locked, crank the arm clockwise to tension your system's fabric.



Raise your shades

Ensure the crank arm is connected to the joining arm at the top of the Ombra® and is folded in an 'L' formation. Hold the top grip of the crank arm in one hand and the bottom grip in the other, then rotate the arm clockwise to raise the shade.

► Systems with Ultra-lock:

Allow the shades to move downwards until you hear a click. This indicates your shade is now unlocked. Once unlocked, crank the arm in a clockwise direction to raise the shade.



Desired height

Simply lower or raise the shade to the desired level and the shade will rest in the position set. To ensure longevity, never forcefully operate the system. If you experience irregular jarring, refer to the 'support' section of this user guide or see your retailer if smooth operation is persistently unachieved.

CLEANING

It is recommended to clean your Ombra® at least every three months, or more frequently for coastal locations to ensure powder coated surfaces are free from dirt, dust and grime.

Always attend to dirt, animal droppings, and stains as soon as possible, to prevent potential deterioration of your system.

Aluminium extrusions can be cleaned with a soft cloth and warm soapy fresh water with a small amount of mild detergent if required.

To maintain fabric cleanliness, please refer to your retailer and find more information about the fabric used by your system. Most external fabrics can be washed with a low pressure hose and soft brush. Always allow the fabric to completely dry before retracting the screen.

In dusty or seafront locations, your Ombra® may benefit from an application of silicone spray lubricant in the side channels to ensure smooth operation.

► Systems with Ultra-lock:

It is important to clean the ultra-lock housing every three months to ensure smooth operation of the mechanism. This involves removing dirt and cobwebs to ensure the Ultra-lock flap moves freely. Silicone spray may be used as a lubricant.

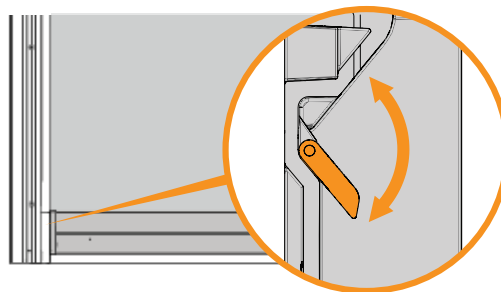

Never clean your Ombra® with abrasive products, chemicals or solvents.



Do not use a pressure hose to clean your Ombra®.



It is extremely important that oil based lubricants are not used, e.g. WD40, as they will attract dust build-up in the channel.

SAFETY & CORRECT PROCEDURE



Do not leave the Ombra® shades down when you are away from home or in extreme weather as it is always recommend to raise shades when wind may exceed 50km/h.



Do not roll the Ombra® shades up when wet (to avoid mould and mildew build up). If the wind may exceed 50km/h, roll up your Ombra® and wait for the weather to settle before attempting to dry your bind again.



Do not force the Ombra® shades up or down if it is jamming. Forcing the Ombra® shades may result in further damage (for example, the zip may be forced out of the side guide, or the fabric may rip). Contact your Ombra® supplier for guidelines of how to fix.



Do not lean persons or objects against the fabric, especially while the system is in motion. Always ensure there are no obstructions while lowering the shades.



Do not operate spring controlled Ombra® shades from the sides.



© 2017-2018 CW Systems - All right reserved

