



**Designed for  
Living Beautifully**

# Create a Space that feels like a holiday.



## 30th Anniversary

Celebrating 30 years as a trusted brand, proudly chosen by businesses and homeowners across Australia for quality, reliability, and long-term performance.



## 100+ Retailers

Available through a trusted network of over 100 authorized dealers across Australia, ensuring access to top-quality products and exceptional service- no matter where you are.



## Total Shading Solution

Combining premium quality with exceptional customer satisfaction, we deliver tailored shading solutions that bring comfort, style and performance closer to you.



## Factory Direct

Our factory-direct production ensures complete quality control, rapid manufacturing and delivery timelines, and significant cost savings offering you greater value without compromise.

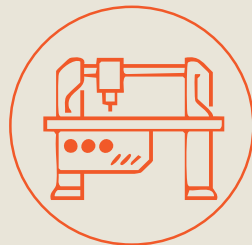

## Advanced Manufacturing Capabilities

With a diverse range of machinery, we optimize every step of the manufacturing process- enabling flexible production, efficient turnaround, and the ability to meet both large-scale and custom order demands with precision and speed.



## Skilled & Experienced Workforce

Our team of highly trained professionals brings exceptional technical expertise and precise quality control to every project. Their experience enables us to deliver customized solutions that meet the unique needs of each customer with accuracy and care.

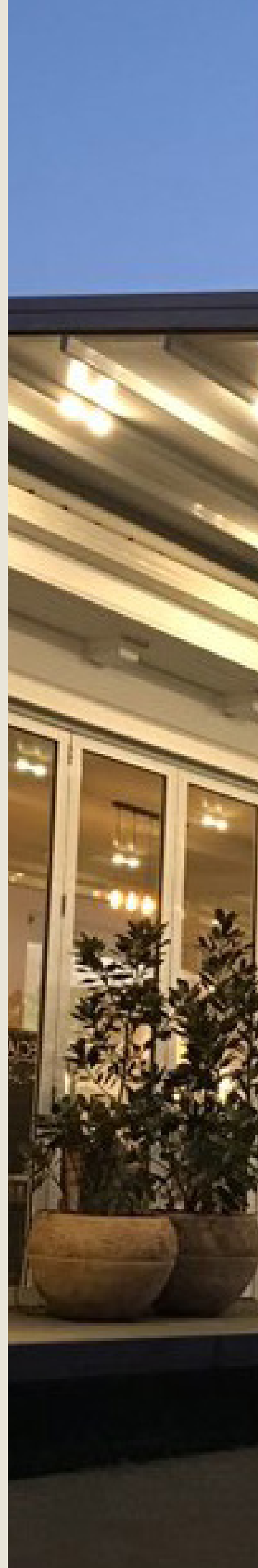



**OZTECH's** range of architectural retractable roof and pergola systems are designed for all-weather performance and are suitable for a wide variety of residential and commercial applications. Whether you're looking to enhance our backyard or deck with a retractable roof, or need a custom-made system to meet the unique requirements of a restaurant or commercial project, there's an OZTECH model to suit your needs.

# 30 Years

SINCE 1996

---

Operating as Australia's largest manufacturer and distributor of residential and commercial pergolas across Australia and New Zealand.

## Superior Craftmanship

Our extensive range of outdoor shading systems is crafted from premium quality materials showcasing world-class engineering in every movement.

## **Elevate your outdoor space**

OZTECH's European-inspired designs seamlessly blends sleek elegance with exceptional protection from the sun, wind and rain. With user-friendly controls, our systems offer the flexibility to effortlessly adapt, enhancing any outdoor area to perfectly suit your needs.



## **Built for Lasting Performance**

Our products are crafted with durability at their core. Expertly engineered and meticulously built, each system delivers outstanding functionality and dependable long-term performance.

## **CONTENTS**

<b>RETRACTABLE ROOF SYSTEM</b>	<b>06</b>
Product Line Ups	08
Product Specs and Comparisons	12
<b>LOUVRE SYSTEMS</b>	<b>14</b>
LOUVRE FLEX	16
GRAND LOUVRE	18
Product Specs and Comparisons	20
<b>TRUBLOCKOUT</b>	<b>22</b>
<b>TRUSCREEN OUTDOOR BLINDS</b>	<b>24</b>
<b>GENIUS OUTDOOR BLINDS</b>	<b>26</b>
<b>GENIUS PIVOT ARMS</b>	<b>28</b>
<b>FOLDING ARM AWNINGS</b>	<b>30</b>

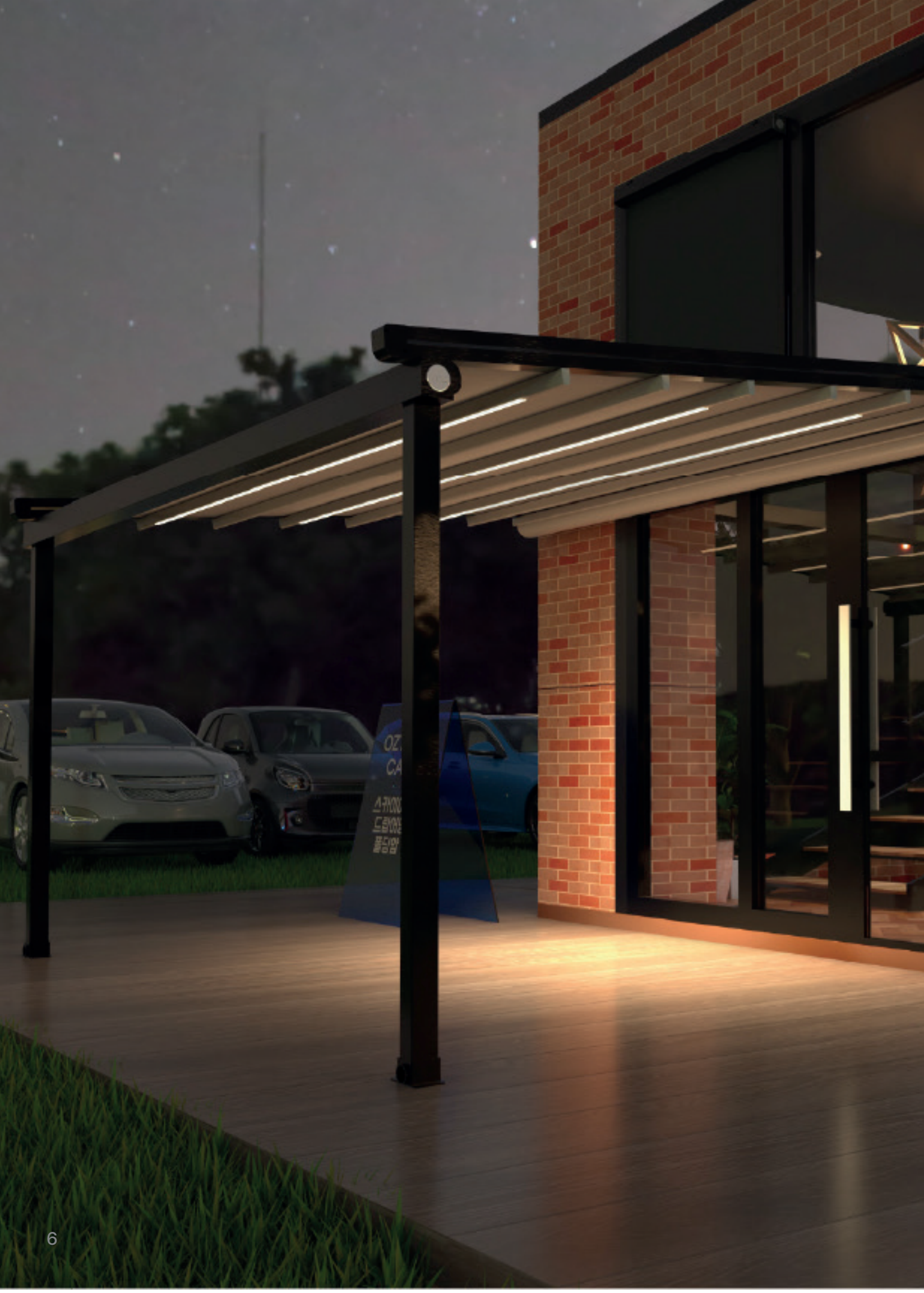



# RETRACTABLE ROOF SYSTEMS

OZTECH's range of architectural retractable roof and pergola systems offers versatile solutions for both residential and commercial applications. Whether it's a retractable roof system for your backyard or deck, or a custom roof system to meet the needs of a restaurant or commercial project, there is an OZTECH model to suit.

# PRODUCT LINE UP

## 01 IZI

### Engineered for Seamless Integration

Designed for maximum versatility, the IZI system features a sleek post-free and gutterless design. It integrates effortlessly into existing structures using specialized brackets and installation techniques. With projections of up to 10 metres, IZI offers a highly adaptable solution for a wide range of outdoor spaces.



## 02 MUSE

### Minimal Design Maximum Impact

The MUSE system redefines our elegance by minimizing the traditional gutter systems, delivering a cleaner, more streamlined aesthetic with unobstructed views. With a maximum projection of 5 metres, it offers a cost-effective solution that balances style, performance, and value- ideal for projects where visual appeal and budget matter.



## 03 TERA

### Our Most Versatile Roof System

The TERA system is Oztech's best-selling retractable roof solution, providing versatile year-round outdoor functionality with a maximum projection of 7m. Featuring a front gutter, it is available in standard, cantilever, freestanding and plaza configurations, offering flexible options to meet diverse design needs. The TERA system is the ideal choice for creating stylish functional outdoor spaces.

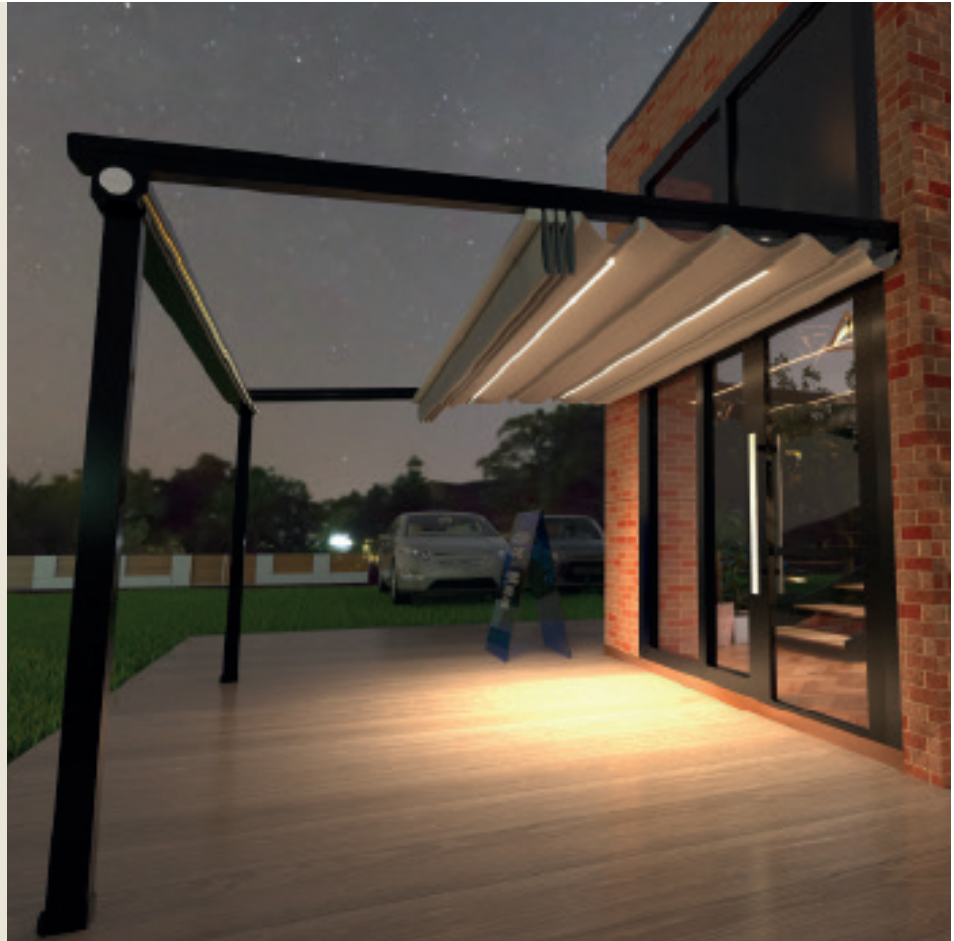

## 04 ARISTO

### Strength for Expansive Spaces

The ARISTO system is engineered for wide and long-span installations, offering extensions of up to 10 meters. Its robust profile ensures exceptional structural stability, maintaining strength and form without bending-- making it the ideal solution for large-scale outdoor areas.

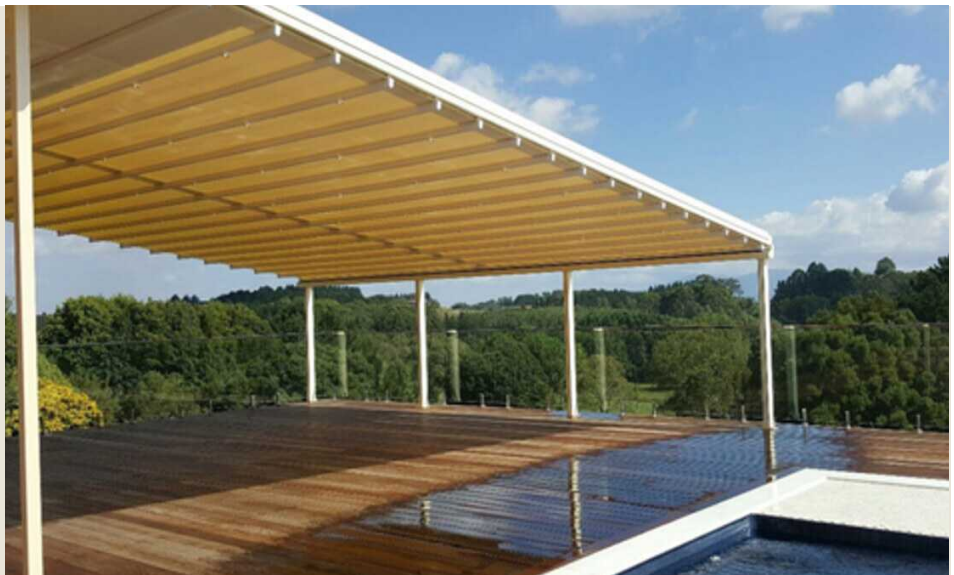

# PRODUCT LINE UP

## 05 HALO

### Elegance in Every Curve

The HALO system features gracefully curved rafters that elevate ceiling height and enhance the sense of openness below. Utilizing patented aluminium bending technology, it achieves optimal curvature for exceptional structural stability and visual impact. With projections of up to 7 meters, HALO offers a strikingly beautiful and highly functional solution for sophisticated outdoor spaces.



## 06 HARBOUR

### Freestanding Elegance with Impact

The HARBOUR system features a striking freestanding, arch-shaped roof that raises the centre for a greater sense of space and openness. Its bold, architectural design not only maximizes coverage but also creates a distinctive atmosphere-making it a compelling visual and marketing feature. Achieve projections of up to 7 meters, or up to 10 meters with reinforced, heavy-duty rafters.



# OPTIONS

## INSTALLATION METHODS



CANTILEVER



FREESTANDING



PLAZA



CANTILEVER + PLAZA

## OPTIONAL EXTRAS

### LED LIGHTING

#### UNI LED



#### MAXI LED



#### OPTION

Light Intensity 4000-5000k  
Light Colour Natural White

### MANUAL SWITCH

#### Integrated Manual Control

A switch button will be attached directly to the product in which the buttons will allow the users to manually control the operation of the product by pressing on it.

### WIND SENSOR

A wind sensor can be paired with the motor, enabling the roof system to automatically retract when a certain wind speed is detected, offering added protection and peace of mind during harsh weather conditions.

### SUN, WIND & RAIN SENSOR

The Wind & Sun sensor automatically responds to changing weather conditions- opening the awning to provide shade on sunny days and retracting it for protection during high winds. It ensures a comfortable and safe outdoor environment with hands-free operation.



### SMART HUBS

## Custom Colour Options

Frame colours are available in any shade from the Dulux Duralloy range, offering flexibility to match your design preferences. Fabric Support bars and end caps come standard in white; however, fabric bars can be powder-coated in your chosen colour for an additional charge.

## Additional Products for side coverings

### Outdoor Blinds



#### GENIUS

An elegant outdoor blind system inspired by European design, featuring a rounded headbox and capable of spanning up to 5 meters with a single screen.



A traditional outdoor blind design favored by many Australians, featuring sharp edges and a rectangular headbox that seamlessly integrates into any home without disrupting visual harmony.





### Infills

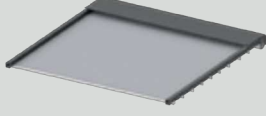

The triangular opening that is exposed on the sides of the roof systems may be covered using a fabric infill. Mesh or PVC fabric is generally used.

# SPECIFICATIONS

## Model Comparison Chart

Model Name	IZI	MUSE	TERA	ARISTO
				
Operation	Motorized	Motorized	Motorized	Motorized
Min. Size (w x p)	2m x 2m	2m x 2m	2m x 2m	2m x 2m
Max. width	13m	13m	13m	13m
Max. Projection	10m	5m	7m	10m
Max. Height	3m	3m	3m	3m
Frame Materials	Aluminium 6063 & 6N01			
Frame Colours	Dullux Duralloy and Duratec colours as well			
Parts Materials	SUS304, SUS316, PA, POM			
Fabric Type	Translucent or Blockout			
Fabric Colour	Over 80 Fabric colours available			
Warranty	5 Years (T&C Apply)			
Wind Rating	Wind rated up to 117km/h			
Rain Resistance	Fully Waterproof Membrane			
Gutter	-	-	●	●
Freestanding	●	●	●	●
Cantilever	●	●	●	●
Weather Sensors	●	●	●	●
UNI	●	●	●	●
LED Lighting				
MAXI	●	●	●	●
Gutter	-	-	●	●
Extra Posts	●	●	●	●
Side Rafter	-	●	●	●
Smart Hub Link	●	●	●	●

SPECIFICATIONS

OPTIONAL ADDONS

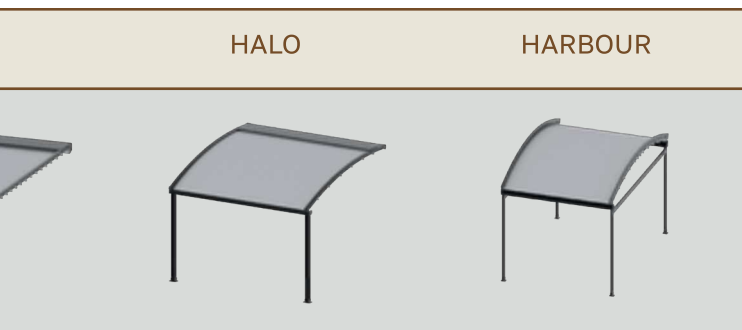

HALO	HARBOUR
Motorized	Motorized
2m x 2m	2m x 2m
13m	13m
10m	10m
3m	3m
Aluminium 6063 & 6N01	
Dullux Duralloy and Duratec colours as well	
SUS304, SUS316, PA, POM	
Translucent or Blockout	
Over 80 Fabric colours available	
5 Years (T&C Apply)	
Wind rated up to 117km/h	
Fully Waterproof Membrane	
●	●
●	●
●	-
●	●
●	●
●	●
●	●
●	●
●	●
●	●

## Section Dimensions (unit: mm)

For projections of up to 7m	
For projections of up to 10m	
Gutter	
Post	
Fabric Support & Puller Profile	
Muse Gutter Bracket	





# LOUVRE

## RETRACTABLE LOUVRE SYSTEM

The Louvre system transforms traditional pergolas into architectural centrepieces, designed to elevate outdoor living with both style and performance. Built for durability and longevity, it offers exceptional heat and water insulation through integrated gutters and specialized gaskets- helping reduce heating costs in colder weather while also providing sound insulation for added comfort. Integrated LED lighting enhances its sleek, modern aesthetic, making the space both elegant and functional. Available in a variety of configurations, including straight or inclined structures, the louvre system offers a versatile solution tailored to suit a wide range of outdoor environments.

# PRODUCT LINE UP



## 01 LOUVREFLEX



### Flexible Protection with Sophisticated Style

LOUVREFLEX features robust, foldable aluminium panels operated by a motorized system, offering reliable protection from sunlight, rain and snow. Designed for both comfort and elegance, it creates a functional and stylish outdoor environment all year round. Ideal for residential patios or commercial venues, LOUVREFLEX combines durability with a sleek, modern look- making it versatile for any setting.



## FEATURES



### Adjustable Louvre Opening

The louvre panels can be easily adjusted to suit the user's preference, allowing precise control over sunlight, ventilation, and shade for maximum comfort.



### Perfectly Sealed When Closed

Engineered for precision, the system ensures a tight, seamless seal when fully closed- providing maximum protection against wind, rain, and external elements.



### LED Lighting

Enhance your outdoor space with integrated LED lighting, creating a bright stylish ambiance for comfortable use and visual appeal- even after dark.



### Harmonious Design

Designed with both form and function in mind, the adjustable louvre opening allow users to control light, airflow, and shade with ease- delivering a seamless blend of comfort and aesthetic appeal

## BLADE PANEL DETAILS

The internal seal blocks water and dust.

Specially Designed Curved Blade



A wide water gutter for an instant drainage system.

## ADVANTAGES



### CUSTOMIZED

Tailored to your project specifications, with delivery and installation completed within 4 weeks of order-ensuring efficiency without compromising quality.

### DURABILITY

Engineered for strength and resilience, the system is built to withstand up to 40cm of wet snow-ensuring long-term stability and performance in harsh weather conditions.

### UP TO 14m

Thanks to an optimized motor system, our design achieves widths of up to 14m in a single system.

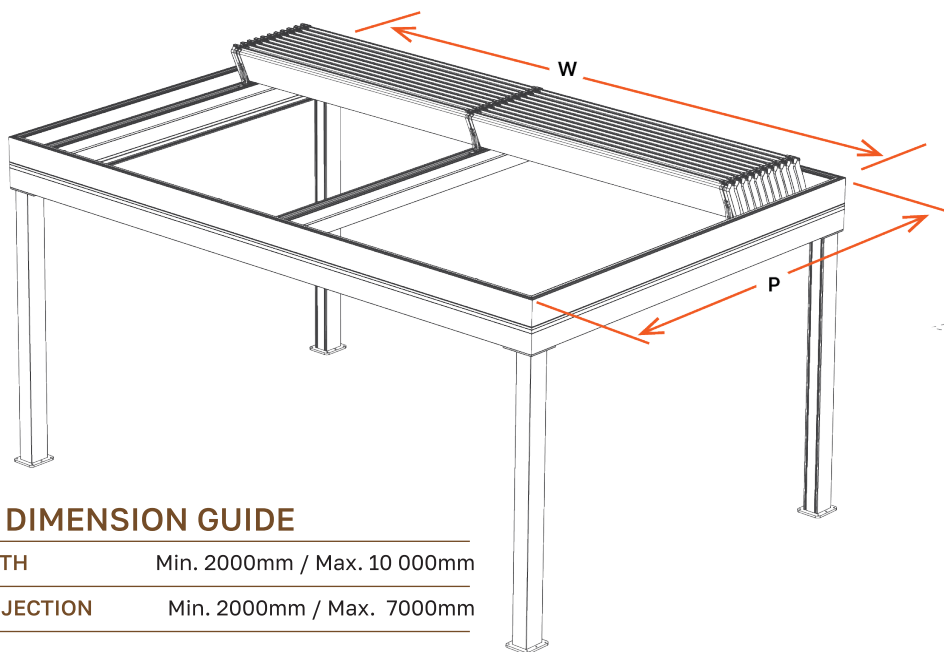

### DIMENSION GUIDE

WIDTH	Min. 2000mm / Max. 10 000mm
PROJECTION	Min. 2000mm / Max. 7000mm

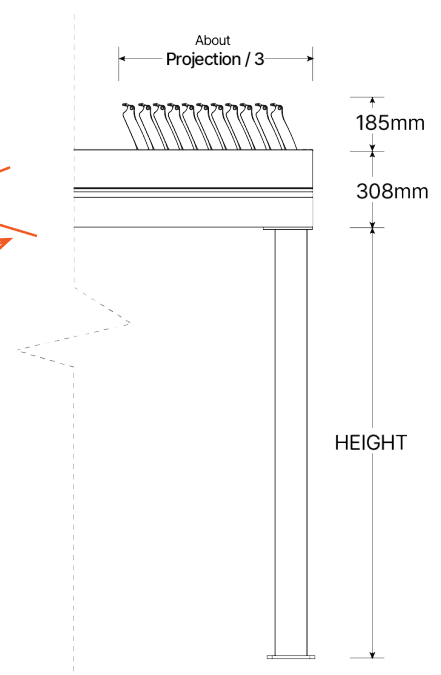



## 02 GRAND LOUVRE



### Advanced Weather - Resistant Pergola

GRANDLOUVRE is a motorised tilting pergola system operated by an actuator motor for smooth, effortless control. Designed to withstand rain and snow, it features a specially engineered drainage system that prevents water infiltration while maintaining structural integrity. Even in wet conditions, the system allows for continuous ventilation, offering both UV protection and airflow-delivering comfort and functionality all year round.



## Features

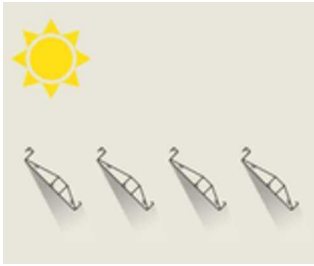

### Sunlight Control

Easily open and close the system to regulate the amount of natural light entering your space- offering optimal comfort, glare reduction, and energy efficiency throughout the day.

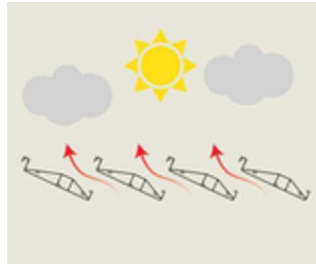

### Ventilation

Designed to promote continuous airflow, the system maintains fresh indoor air circulation- even on rainy days- without compromising protection from the elements.



### Rainwater Protection

Designed to promote continuous airflow, the system maintains fresh indoor air circulation- even on rainy days- without compromising protection from the elements.

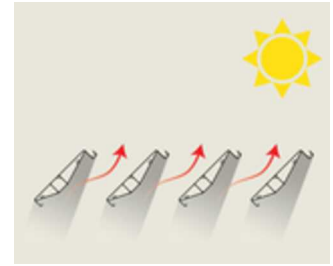

### UV Protection

Provides effective UV shielding while allowing smooth airflow through adjustable openings- delivering comfort, protection and ventilation in one seamless system.

## TECHNICAL INFORMATION



Linear Acuator Motor  
2300 ~ 2500N



Supports a maximum  
width of up to 4.0M.

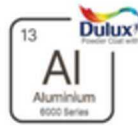

All Profiles(6063) are  
Hige grade aluminium.



All Plastic parts are UV  
stabilized and component  
are Stainless Steel.

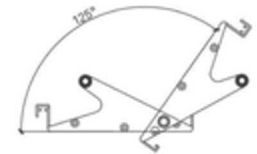

Blade angle opens up to 125  
degrees.

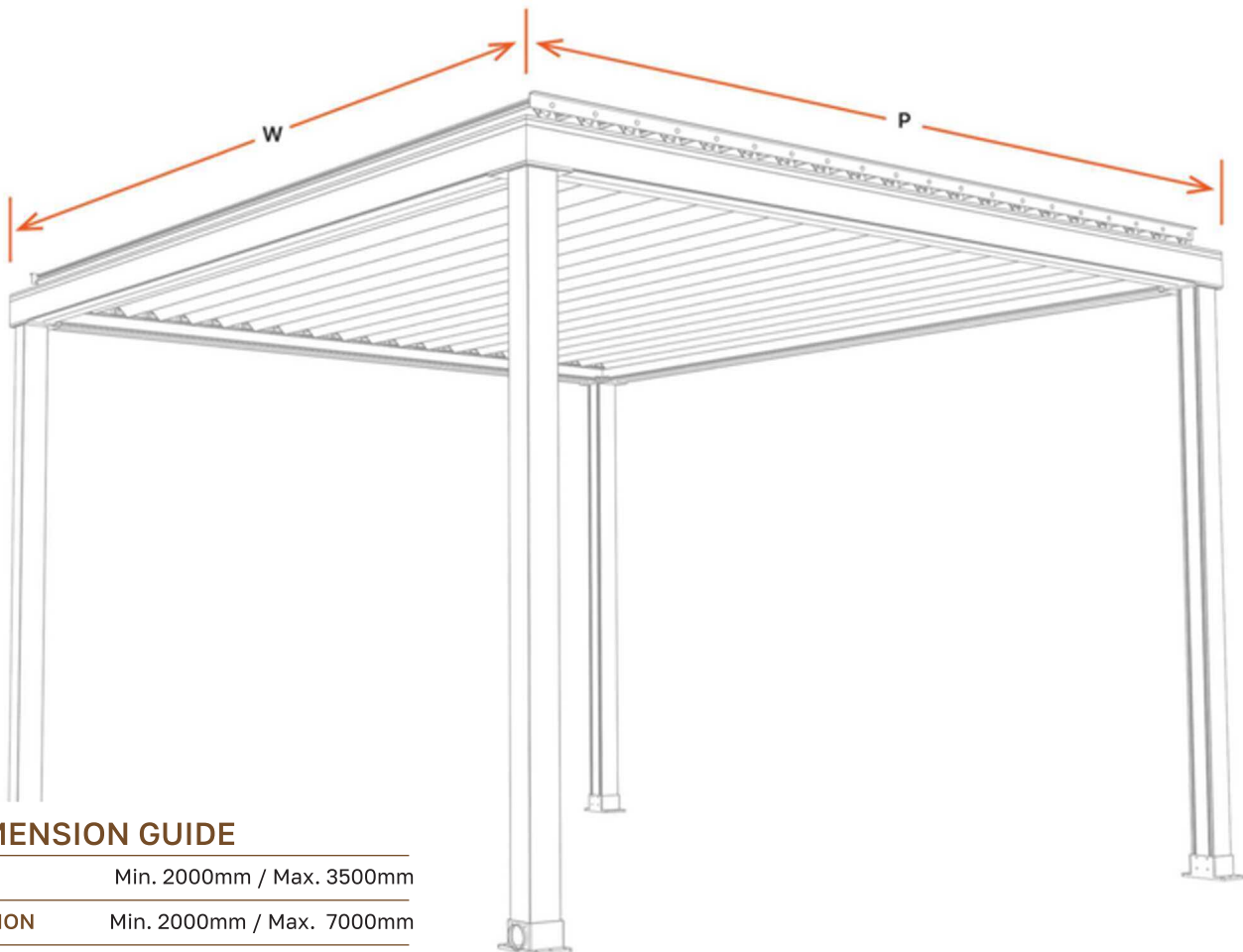

### DIMENSION GUIDE

WIDTH	Min. 2000mm / Max. 3500mm
PROJECTION	Min. 2000mm / Max. 7000mm

# SPECIFICATIONS

## Comparison Chart

PRODUCT		LOUVRE FLEX				
						
DIMENSIONS	Modules	Single (2 Rafters)	Double (3 Rafters)	Triple (4 Rafters)	Quadruple (5 Rafters)	
	Width	Max. 3500mm	Max. 6000mm	Max. 8000mm	Max. 10 000mm	
	Projection	Min. 2000mm/ Max. 7000mm				
	Height	Max. 3000mm				
Frame Colour		Dulux Duralloy and Duratec colours available				
OPTIONS	Extra Posts	●	●	●	●	
	LED	Gutter LED	●	●	●	●
		+ IOT	●	●	●	●
	Operation	Fully motorised remote control or hard-wired double motors available.				
	C-BUS	●	●	●	●	
	Motion Sensor	●	●	●	●	
	Sun & Wind Sensor	●	●	●	●	
SIDE FINISHINGS	Folding Door	-	●	●	●	
	Sliding Door	-	●	●	●	
	Fixed Window	-	●	●	●	
	Outdoor Drop	-	●	●	●	
TEST	Snow	400-800mm (Wet Snow)				
	Wind	114-147 km/h				
Warranty		2 Years				
Lead Time		3-4 Weeks				
MATERIAL	Frame	Aluminium 6063 & 6061				
	Part	SUS 304/316, PA, POM				

## GRAND LOUVRE



fters)	Single only
m	Max. 3500mm
	Min. 2000mm/ Max. 7000mm
	Max. 3000mm
	Dulux Duralloy and Duratec colours available
	●
	●
	●
	Fully motorised remote control or hard-wired double motors available.
	●
	●
	●
	●
	●
	●
	●
	400-800mm (Wet Snow)
	114-147 km/h
	2 Years
	3-4 Weeks
	Aluminium 6063 & 6061
	SUS 304/316, PA, POM

\*Projection is limited in certain areas depending on the blade width

## Section Dimensions (unit: mm)

### LOUVRE FLEX

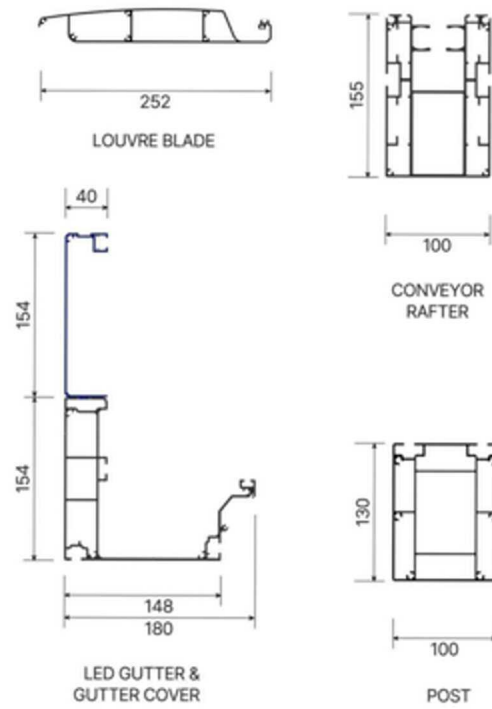

### GRAND LOUVRE

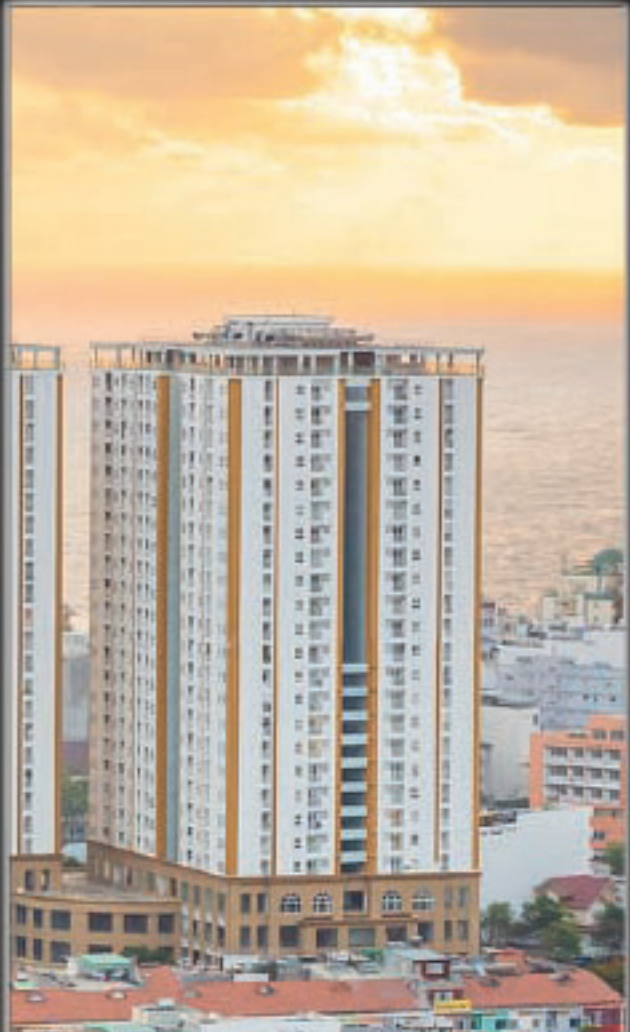

**TRU  
BLOCKOUT**  
100% Block Out Blinds System



DESIGNED AND TESTED IN AUSTRALIA  
FOR **ZERO LIGHT LEAKAGE AND A  
BETTER NIGHT SLEEP.**

TruBlockout is a revolutionary new block out blind system that delivers 100% block out and sets the new standard for blackout blind applications, as well as a frame and channel structure designed for zero light leakage on imperfectly square window frames.

## SYSTEM DETAILS

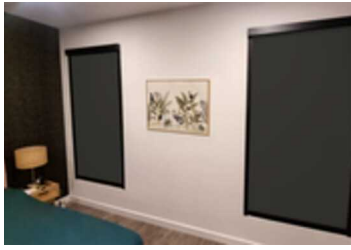

One size slimline pelmet fully concealable within most window reveal. Face mount achieved with no extra parts or extrusions.



Suitable for large windows with up to 3m drop.



Remote control, Smart phone control, Voice control or full integration into your home/office automation system.



Charge via a 240V charging cord or DC battery storage pack to the bottom of the frame. No reaching up.



ZigBee wireless technology and cast aluminium end cap (not plastic) for added strength



Integrated USB-C charging port conveniently concealed and located at the bottom right-hand corner of the frame.



Ultra thin (0.3mm) fire rated, childsafe and Smart Block fabrics present peace of mind and enables a 3 meter drop.

## FEATURES



### FABRIC COLOURS

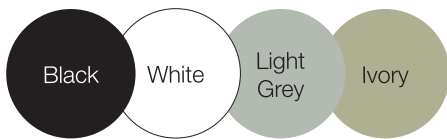

### FRAME COLOURS

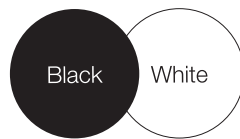

## ADVANTAGES

Despite being thinner than the competition for a slimmer, sleeker blind design, the fabric choices available in the TruBlockout system offer total black out of light.

- Motorisation as standard
- Remote control included
- Suitable for app and smart home control
- Easy charging, no reaching up
- Sleek and flush fitting design
- No messy cords or wand

## SPECIFICATIONS

<b>MATERIAL</b>	ALUMINIUM 6063
<b>WIDTH</b>	Min. 530mm/ Max. 3000mm
<b>DROP</b>	Min. 530mm/ Max. 3000mm ** WIDTH > 2800mm/ DROP: 2800mm LIMITED
<b>FRAME COLOUR</b>	White, Black
<b>FABRIC</b>	100% Polyester + Acrylic Coating (Flame Retardant)
<b>MOTORISED</b>	BATTERY MOTOR (WIDTH > 2000mm TB25 / > 2800mm TB28)





# TRU SCREEN



**Privacy & Shade.  
Anytime You Need.**

TruScreen outdoor blinds combine advanced engineering with premium materials, featuring high-quality channel rails, spline, and suspension systems for superior durability and long-lasting performance. Designed for a seamless, custom fit, TruScreen offers a clean, sophisticated aesthetic- ideal for homeowners seeking both function and refined style.

## TECHNICAL INFORMATION

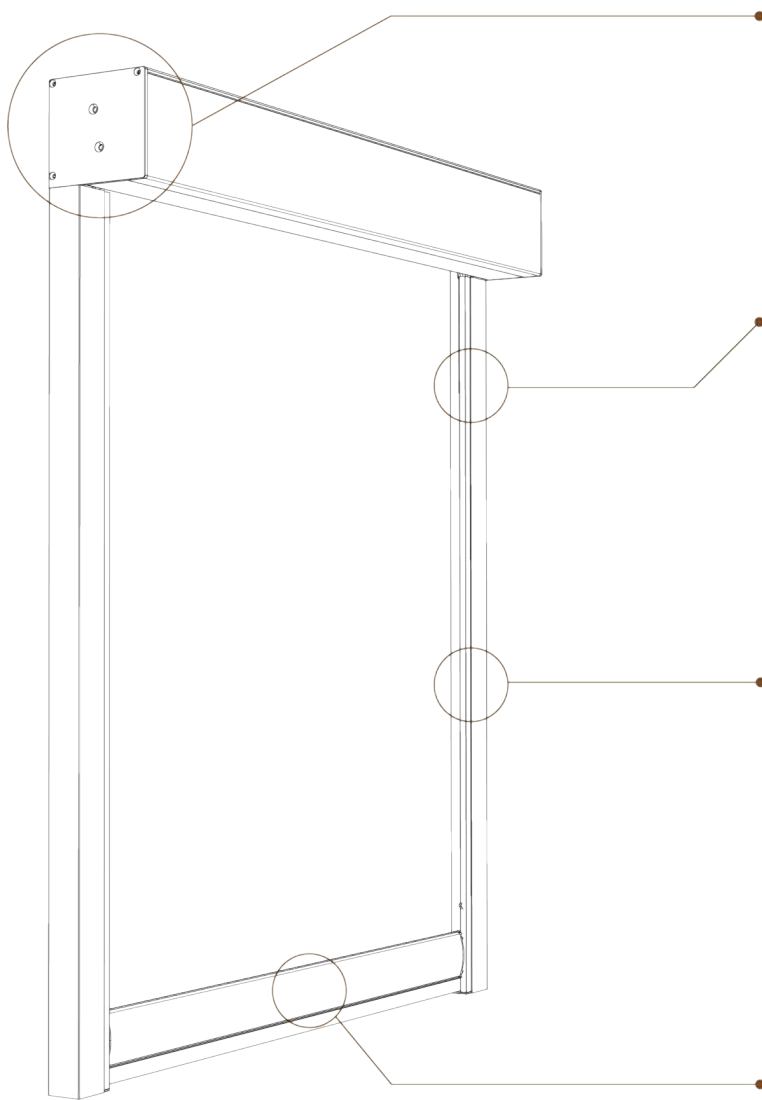

## SYSTEM DETAILS



### Reduced vibration Quiet Operation

Reduces vibration from the motor and noise from the headbox. Allows for quiet operation and enhanced performance.

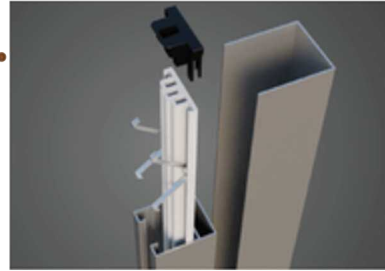

### Optimized Fabric Tension System

Optimized fabric polymer channels, tension polymer and tension clips ensure optimal fabric tension, providing the best solution for maintaining fabric stability at all times.

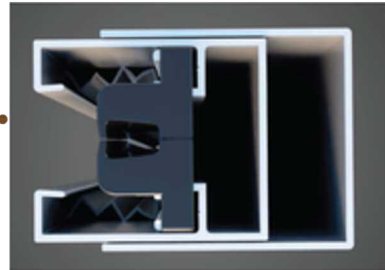

### Dual Channel System

The two separate channels enable flexible, adjustable installation - allowing seamless integration into a wide range of architectural environments and site conditions.



### Enhanced Bottom Bar Stability

The specially designed bottom bar minimises movement even at wide widths, while the split bottom bar caps secure the zip more effectively.

## FEATURES

- Obstacle Detection Motor
- Motorized or Manual (gear or spring) Operation
- Sunlight & UV Protection
- Maximized Usable Space
- Wide Coverage & Color Options
- Proudly Australian Made

## SPECIFICATIONS

<b>MATERIAL</b>	ALUMINIUM 6063, CLOSED HEADBOX
<b>WIDTH</b>	Min. 900mm / Max. 6500mm
<b>DROP</b>	Min. 1000mm / Max. 3500mm
<b>STANDARD COLOURS</b>	Sand texture White, Black, Monument, Woodland Grey, Classic Cream and Paperbark
<b>FABRICS</b>	Mesh, Clear/Tinted PVC, or Acrylic Canvas
<b>OPERATIONS</b>	Obstacle Detection Motorization / Manual Crank

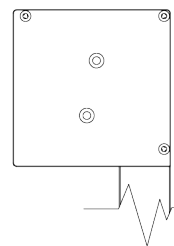

Truscreen Headbox  
135mm x 135mm

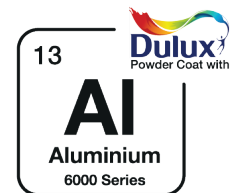

All profiles are high grade aluminium. 6 standard colours with non-standard colours available.

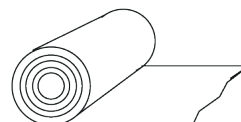

Various Colours  
Mesh or Canvas

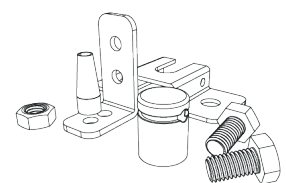

All plastic parts are UV stabilized and components are Stainless Steel



## DROPAWNING SYSTEMS

# GENIUS

**Designed for Comfort, Built for Life**

The Genius Drop Awning Range utilises a slimline headbox that offers complete protection of the fabric when the system is not in use. Unlike the traditional drop awnings, our range does not require any additional fixings to keep the awning in place. The Genius Drop Awning Range is a fantastic solution for all areas and applications and is available in both manual and motorised.



## SPECIFICATIONS

<b>MATERIAL</b>	ALUMINIUM 6063, CLOSED HEADBOX
<b>HEADBOX DIMENSIONS</b>	STANDARD: 120mm x 125mm ULTRA: 140mm x 150mm
<b>CHANNEL DIMENSIONS</b>	35.5mm x 32mm
<b>STANDARD DIMENSIONS</b>	White, Black, Charcoal, Woodland Grey
<b>OPERATIONS</b>	MOTOR, MANUAL, GEAR, SPRING TENSION
<b>TYPE</b>	ZIP / WIRE GUIDE / DROP / PIVOT ARM

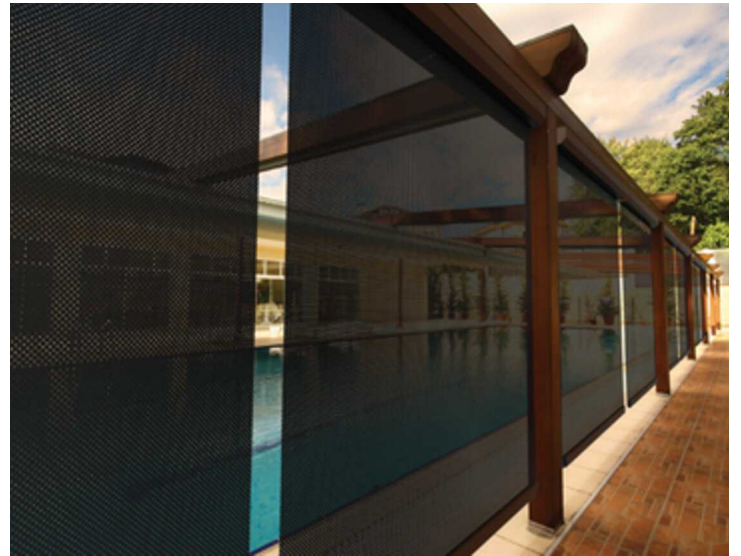

## TECHNICAL INFORMATION

	ZIP	WIRE GUIDE	DROP
<b>PRODUCT IMAGE</b>			
<b>SIDE RAIL</b>	Ⓐ Zip System Side Channel	SUS Wire	-
<b>LOCK</b>	Ⓐ Hook & Stopper (Spring Operation Only)	-	D-Ring & Strap
<b>OPERATION</b>	Motorised Manual (spring & crank)	Motorised Manual (spring & crank)	Motorised Manual (spring & crank)

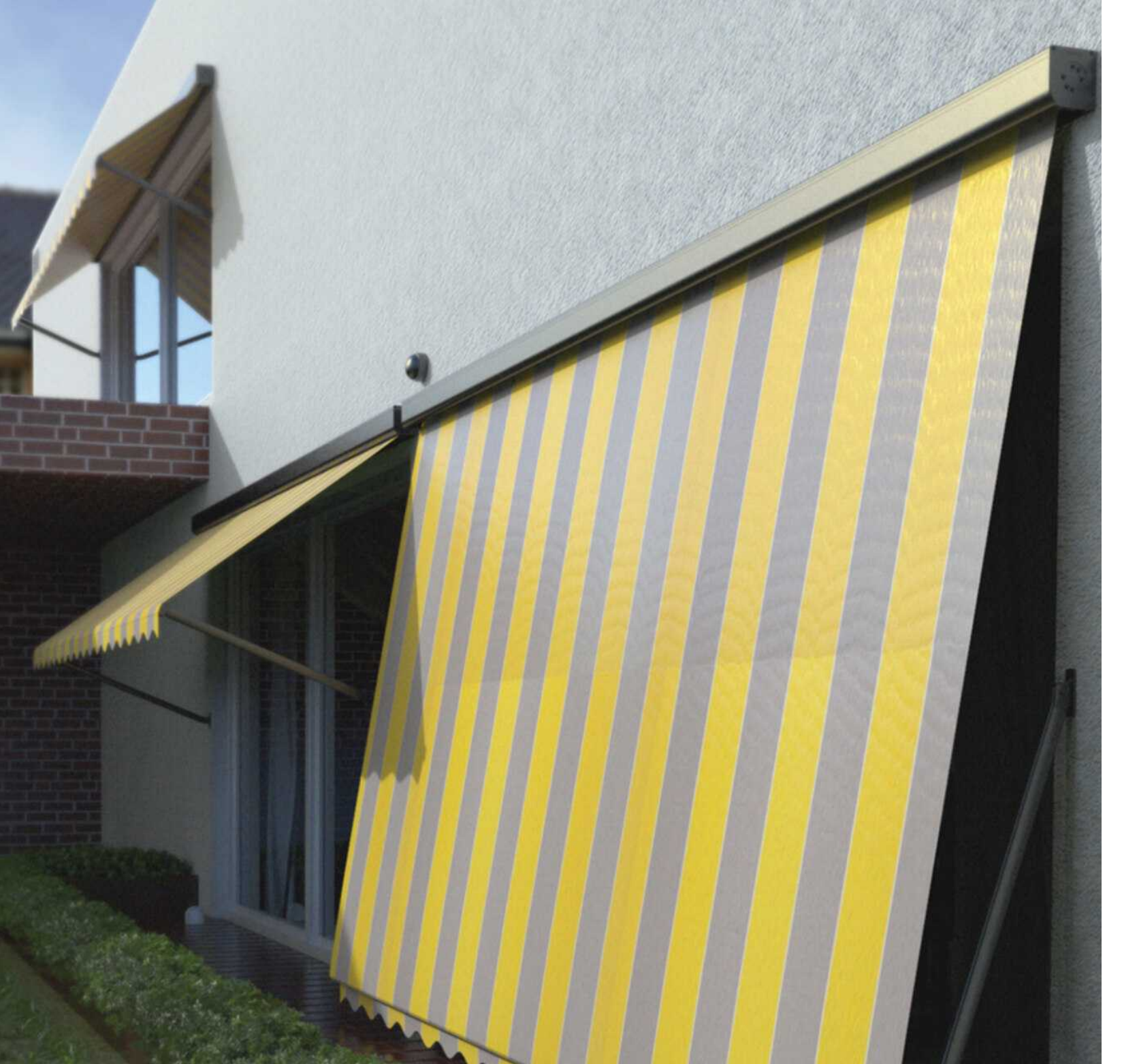

DROPAWNING SYSTEMS

# GENIUS

PIVOTARM



**THE ULTIMATE BLIND SOLUTION  
FOR ANY OUTDOOR AREA OR WINDOW**

GENIUS PIVOT system provides both UV protection and privacy. It can be installed up to 6 meters wide while maintaining fabric tension even in strong winds. The tension arms rotate up to 170 degrees, effectively blocking sunlight and creating a perfectly private space.

## TECHNICAL INFORMATION

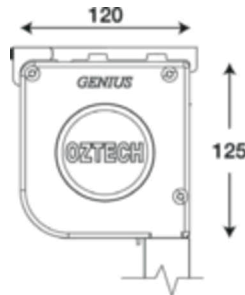
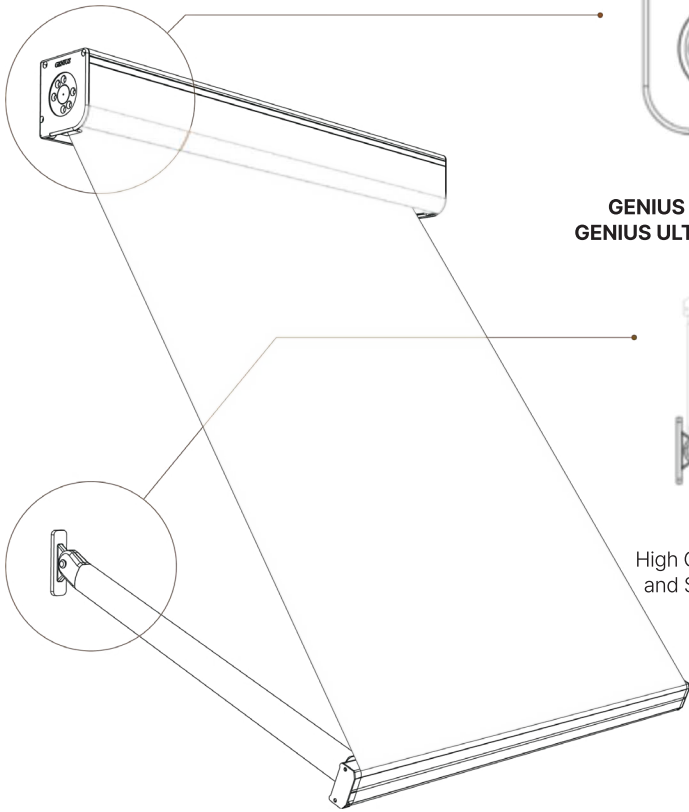

**GENIUS** - 120mm x 125mm  
**GENIUS ULTRA** - 140mm x 150mm

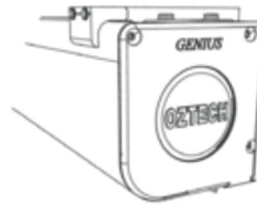

Top and Ceiling mount as well as Wall fix brackets available.



All plastic parts are UV stabilized and components are Stainless Steel.

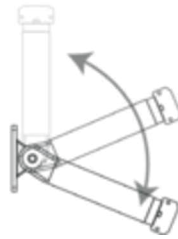

High Grade Pivot Arm and Spring Tension.



Various Colours Mesh or Canvas



All profiles are high grade aluminium. 2 standard colours along with numerous non-standard colours available.

## SYSTEM DETAILS

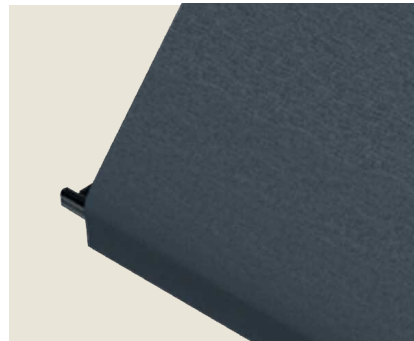

### Invisible securing

All fixings and screws are concealed. The channel and fabric are easily accessible for efficient maintenance or fabric replacement if needed.

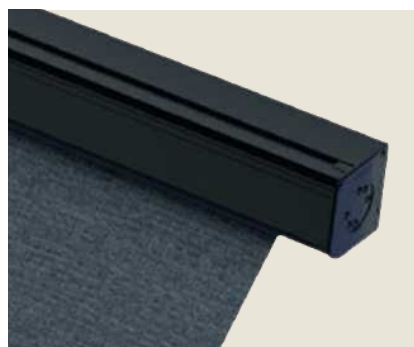

### Full Cassette Headbox

The fabric is fully enclosed in a sleek cassette, protecting it from UV exposure and external elements when the system is closed.



### High performance pivot arm tension

The pivot arm maintains constant fabric tension, preventing it from slipping out of the channel even in windy conditions.

## FEATURES

- High grade spring tension arms
- 4 standard colours
- Up to 6m wide
- UV protection and added privacy
- Australian Made

## SPECIFICATIONS

<b>TYPE</b>	ALUMINIUM 6063, CLOSED HEADBOX
<b>WIDTH</b>	MIN. 900mm, MAX. 6000mm
<b>DROP</b>	MIN. 1000mm, MAX. 3000mm
<b>FRAME COLOUR</b>	White, Black, Charcoal, Woodland Grey
<b>FABRIC</b>	Mesh or Canvas fabrics
<b>OPERATIONS</b>	Obstacle Detection Motorisation/ Cord/ Tape/ Gear



## RETRACTABLE FOLDING ARM AWNINGS

Versatile Outdoor Shading Solutions

Retractable folding arm awnings are a stylish and practical solution for enhancing outdoor living areas. Designed to provide flexible shade and protection, they shield against harsh UV rays and adverse weather while maintaining an open, airy environment when retracted. Ideal for patios, balconies, cafes, and commercial spaces, these awnings combine functionality with modern aesthetic.

### PRODUCT LINE UP

## *Family Kompakt*

FULL CASSETTE

This high-quality cassette awning fits flushed against the wall and offers a high degree of comfort with superb technical features. The *Family Kompakt* combines the protective function of a cassette awning with the ease of installation of an open awning: the back is open, allowing for easier access of the square bar as well as ease of installation. The cassette can also be supplied without side end caps for recess fit installation.



## MILLENNIUM

FULL CASSETTE

MILLENNIUM is based on a self-supporting full cassette. The back is fully encased, making it the ideal awning for roof mounts or under-eave fixings. It reaches a generous 7m meters in width. Choose your favourite colour from a host of awning fabrics and

## *Family Basic*

SEMI-CASSETTE

The distinctive features of our FAMILY BASIC Folding Arm Awning range is its superior quality, ease of operation and high value retention. Its classic design lends tranquillity to the home and bestows a holiday atmosphere.



## SYSTEM DETAILS



### Front Profile

Arm brackets of high-strength aluminium allow with support and high-impact screw, upper arm fork of forged aluminium.

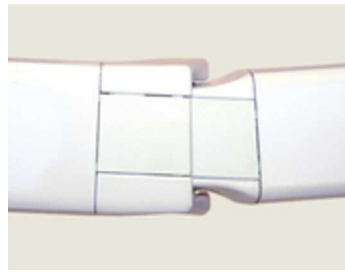

### Arm Bracket

In the central hinged arm joints, a plastic sheath prevents soiling and corrosion of the double cable and extends its service life.



### Spring Tension Arms

The fabric cover shell offers an elegant solution for concealing the fabric roller.



### Fabric Cover Shell

The front profile brackets connect the arm securely to the front profile and permit easy adjustments of the angle.



### Full Cassette



### LED Lighting

SPECIFICATION	<i>Family</i>	<i>Family Basic</i>	<i>Family Kompakt</i>	MILLENNIUM
<b>TYPE</b>	OPEN-HOODED	SEMI-CASSETTE	FULL-CASSETTE	FULL CASSETTE
<b>WIDTH</b>	Max. 9000mm	Max. 9000mm	Max. 9000mm	Max
<b>PROJECTION</b>	1600mm, 2100mm, 2600mm, 3100mm, 3600mm	1600mm, 2100mm, 2600mm, 3100mm, 3600mm, 4100mm	1600mm, 2100mm, 2600mm, 3100mm, 3600mm, 4100mm	1600mm, 2100mm, 2600mm, 3100mm, 3600mm
<b>DRIVE</b>	Motor Drive (electric motor) / Crank Drive (bevel gear) possible on request			
<b>SCOPE OF SUPPLY, ATTACHMENTS</b>	Includes wall consoles for concrete B25 C20/25 (For anchor Bolots: FAZ II M 12)			
<b>FRAME COLOURS</b>	6 Standard Colours (White, Black, Charcoal, Paperbark, APO Grey, Woodland Grey) Non-standard powder coat colours will incur an additional charge.			
<b>FABRICS</b>	Acrylic: A variety of fabric brands and colours to choose from.			
<b>OPTIONS &amp; SENSORS</b>	<input type="checkbox"/> Sun & Wind Sensor	<input type="checkbox"/> Motion Sensor	<input type="checkbox"/> Radio remote control/ electric motor with integral radio control	
<b>LED LIGHTING</b>	Frame LED LED ARMS	Max. 9000mm Max. 4000mm	Max. 9000mm Max. 4000mm	Max. 9000mm Max. 3000mm
		Max. 7500mm Max. 3000mm		

An additional light control box for remote control is provided.  
For lengths over 5.5m, the Frame LED cover may come in 2 sections. Please be advised.

## INSTALLATION

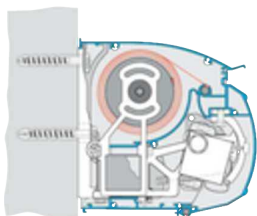

**Wall fixed**  
With Wall bracket

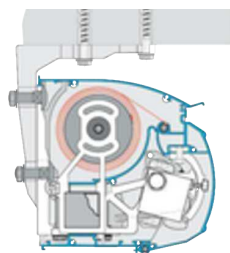

**Top fixed**  
With Top mounting bracket

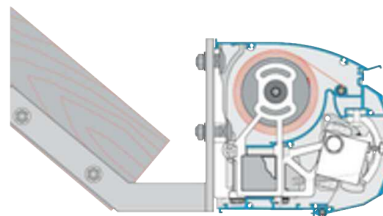

**Rafter fixed**  
With 10 or 22 Degree Rafter Bracket

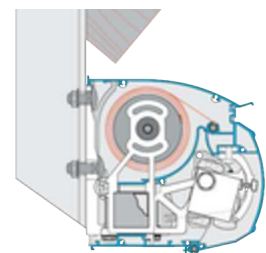

**Rafter fixed**  
With Roof tile bracket set

